

SS220K-23

Miniature Slide Switches

RoHS Compliant



Features

1. For Embedded Use

The switch can be embedded in the plastic mold housing of equipment or power tools to reduce the overall size.

2. Power Switch Application

Suitable for power supplies where small size and large current capacity is required (inrush current: 70 A).

3. Anti-welding (forced separation) mechanism

In case the contacts are welded, the switch is structured to force separation of the contacts.

Specifications

Rating	Resistive load	20A 250VAC
	Inductive load	250VAC 70A (p.f.=0.7)/20A (p.f.=0.9)
Initial contact resistance	20mΩ max. (1A 2~4VDC)	
Dielectric strength	250VAC 1 minute	
Insulation resistance	100MΩ min. (500VDC)	
Electrical life	10,000 operations.	
Operating force	3.43~7.35 N	
Operating temperature range	-10~+50°C	
Storage temperature range	-20~+70°C	

Terminal style

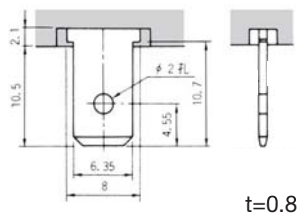

(TAB terminals)

t=0.8

Structure

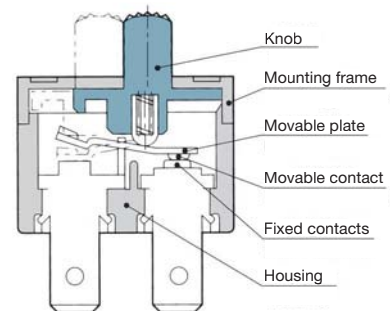

SS220K-23-Z DPST



#250
(TAB terminals)

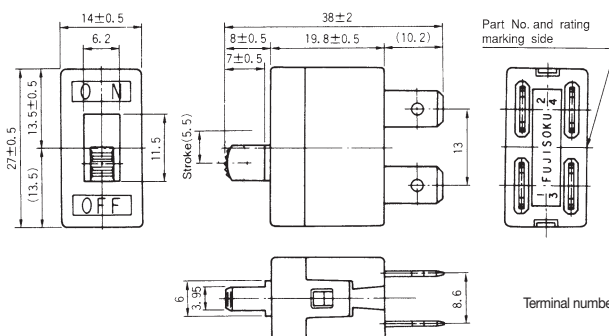

Terminal numbers are shown on the bottom of the switch.

Switchingfunction	Viewed from part No. marking side	
Part No.	ON	OFF
★SS220K-23-Z	ON	OFF
Connecting terminals	1-2 3-4	—