



Electrical specifications

Center Frequency: 897.5 MHz
Bandwidth: 35 MHz
VSWR: 1.7 : 1 min.
Input / Output Impedance: 50 Ohms
Passband: 880-915 MHz
Passband Insertion Loss: 3.0 dB max
Passband Ripple: 1.0 dB max
Rejection: 8dB min at 925-960 MHz
Rejection 2: 30dB min at 726-761.4 MHz
Rejection 3: 50dB min at 1187.2-1222.2 MHz
Power Handling: 3 W max

Mechanical

Mounting Method: SMT
Dimensions: 14mm x 13mm x 4.5mm

Environmental

Operating Temperature: -20°C to 70°C
Storage Temperature: -50°C to +90°C

This product is RoHs compliant.

Outline Drawing:

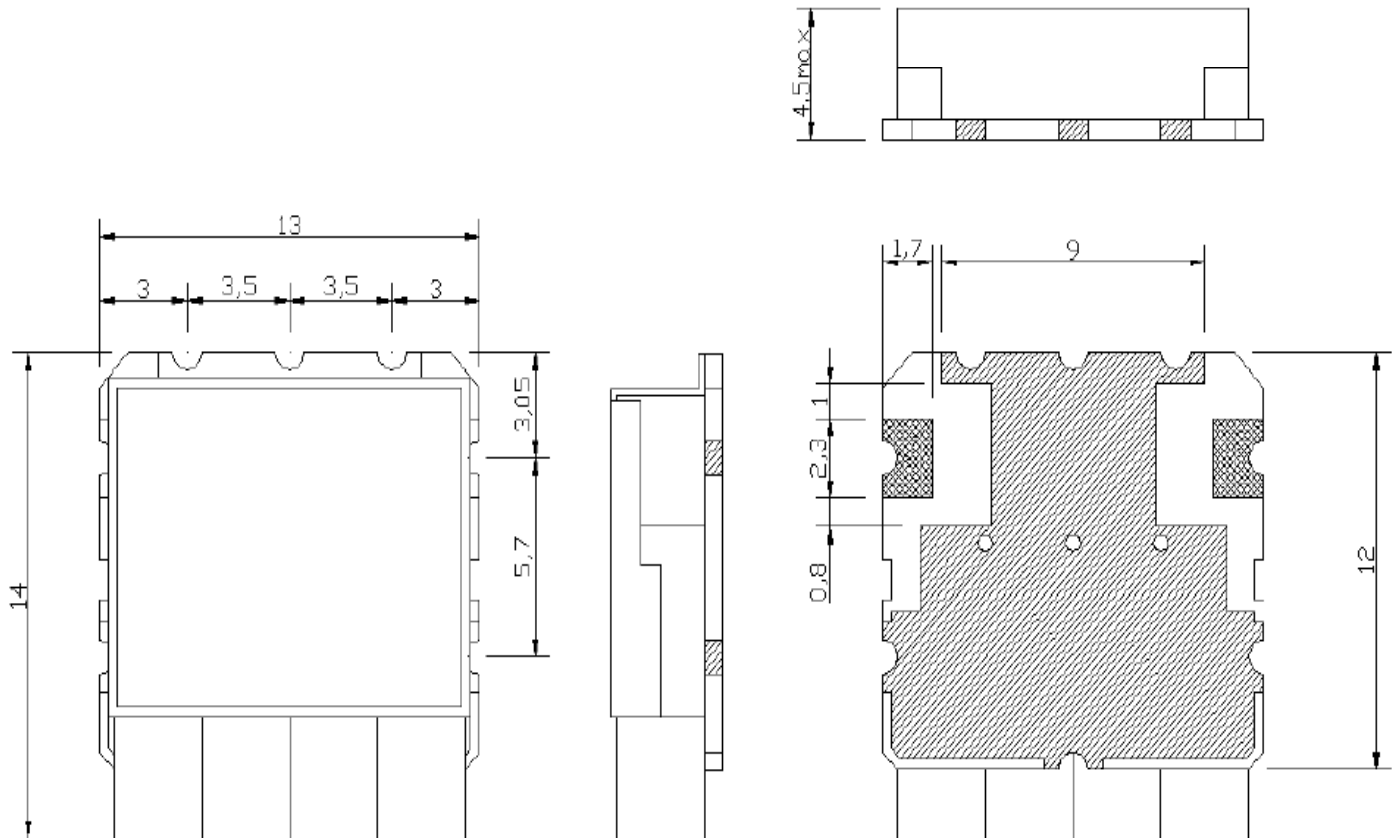

Unit:mm
Tolerance:±0.3



Foot Print:

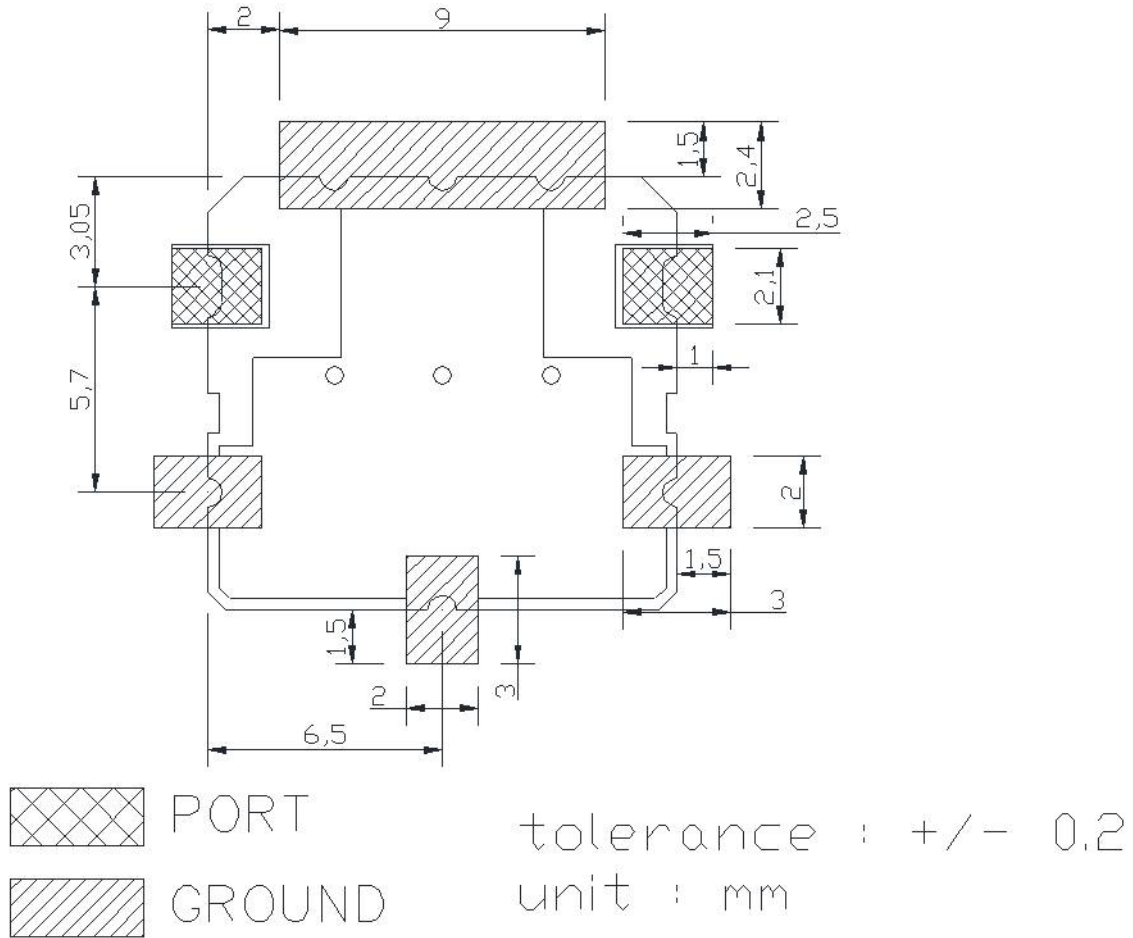



897 MHz Ceramic Bandpass Filter

ANATECH ELECTRONICS INC
RF & Microwave Filters & Products

Part Number: AM897B1284



Response Plots:

