

APPROVED: _____
 DATE: _____ TITLE: _____

Rev	AWO #	Description	Date	Appr
-	11227	RELEASED	4/11/11	
A		REVISED SHAPE & SPEC.	4/10/12	
B		UPDATE DRAWING	11/8/17	AY/TY

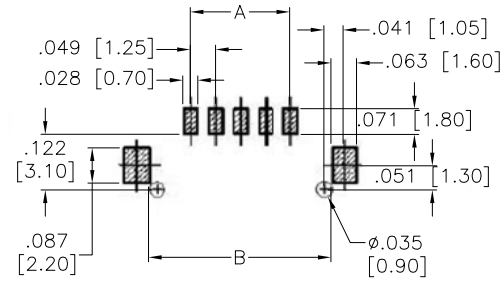

RECOMMENDED PCB LAYOUT

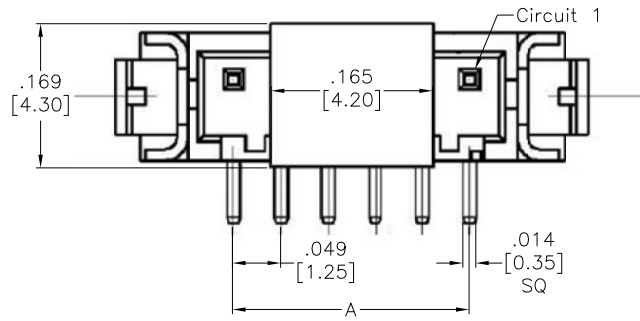
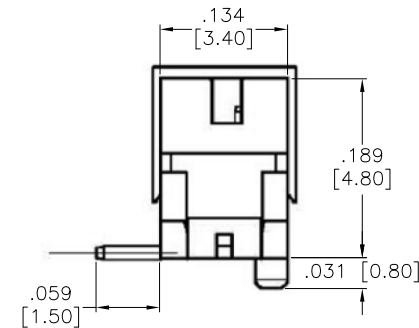
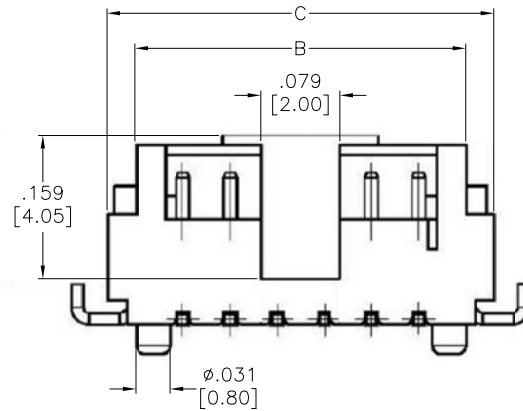

Positions: 02 thru 15

A = .049 [1.25] X No. of Spaces

B = .049 [1.25] X No. of Spaces + .114 [2.90]

C = .049 [1.25] X No. of Spaces + .197 [5.00]

PACKAGED ON TAPE & REEL

SPECIFICATIONS:

Material:

Insulator: Hi-temp thermoplastic, rated UL 94V-0

Insulator color: Natural

Contacts: Phosphor Bronze, Tin plated

Solder Tabs: Brass, Tin plated

Electrical:

Voltage rating: 100V AC,DC

Current rating: 1A AC,DC

Contact resistance: 20 mohms max

Insulation resistance: 500 Mohms min

Withstanding voltage: 500 VAC for 1 minute

Environmental:

Lead free, RoHS compliant.



UNLESS OTHERWISE SPECIFIED ALL DIMENSIONS ARE INCHES [MM] TOLERANCES: EXCEPT AS NOTED			
INCHES		HOLES	
.X	± .10	∅X	± .10
.XX	± .020	∅XX	± .015
.XXX	± .015	∅XXX	± .010

APPROVALS		DATE
DRAWN	DY	4/11/11
CHECKED		
APPROVED		

ADAM TECH

909 Rahway Avenue, Union, NJ 07083

Phone: 908-687-5000 Fax: 908-687-5710

TITLE: .049 [1.25] PITCH WIRE TO BOARD HEADER
 STRAIGHT, SMT TYPE

SIZE	PART NO.	REV.
X	125SH-C-XX-TS-SMT-T/R	B
REF: S00123T	SCALE: NTS	SHEET 1 OF 1