

MATERIAL

Zinc-plated steel housing.

STANDARD EXECUTIONS

- **RMN-AN:** (AlNiCo) Aluminium-nickel-cobalt magnet, resistant to temperatures up to 450°C.
- **RMN-ND:** (with blue inked adhesive surface): (NdFeB) Neodymium- iron-boron magnet, resistant to temperatures up to 80°C.

See Guidelines for the choosing (on page 1180).

FEATURES AND APPLICATIONS

RMN cylindric retaining magnets are shielded magnetic systems with high performances and moderate overall dimensions.



| Conversion Table 1 mm = 0.039 inch | | | |
|---------------------------------------|------|----|------|
| D | | | |
| mm | inch | mm | inch |
| 6 | 0.24 | 25 | 0.98 |
| 8 | 0.31 | 32 | 1.26 |
| 10 | 0.39 | 40 | 1.57 |
| 13 | 0.51 | 50 | 1.97 |
| 16 | 0.63 | 63 | 2.48 |
| 20 | 0.79 | | |

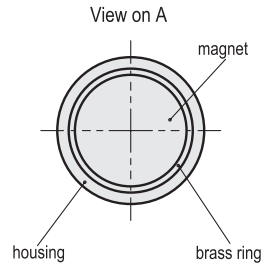
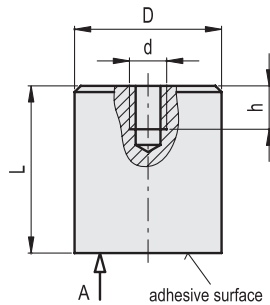

RMN-AN

METRIC

| Code | Description | D+0.2-0.2 | d | L+0.2-0.2 | h | Nominal adhesive forces* [N] | ⚖️ |
|--------|-------------|-----------|-----|-----------|----|---------------------------------|------|
| 502301 | RMN-AN-6 | 6 | M3 | 20 | 5 | 2 | 4 |
| 502303 | RMN-AN-8 | 8 | M3 | 20 | 5 | 4 | 8 |
| 502305 | RMN-AN-10 | 10 | M4 | 20 | 7 | 8.5 | 11 |
| 502307 | RMN-AN-13 | 13 | M4 | 20 | 7 | 12 | 19 |
| 502309 | RMN-AN-16 | 16 | M4 | 20 | 7 | 20 | 30 |
| 502311 | RMN-AN-20 | 20 | M6 | 25 | 7 | 40 | 55 |
| 502313 | RMN-AN-25 | 25 | M6 | 35 | 9 | 60 | 121 |
| 502315 | RMN-AN-32 | 32 | M8 | 40 | 9 | 160 | 212 |
| 502317 | RMN-AN-40 | 40 | M8 | 50 | 9 | 240 | 437 |
| 502319 | RMN-AN-50 | 50 | M10 | 60 | 12 | 400 | 793 |
| 502321 | RMN-AN-63 | 63 | M12 | 65 | 14 | 660 | 1273 |

RMN-ND

| Code | Description | D+0.2-0.2 | d | L+0.2-0.2 | h | Nominal adhesive forces* [N] | ⚖️ |
|--------|-------------|-----------|-----|-----------|----|---------------------------------|------|
| 502401 | RMN-ND-6 | 6 | M3 | 20 | 5 | 6 | 4 |
| 502403 | RMN-ND-8 | 8 | M3 | 20 | 5 | 12 | 8 |
| 502405 | RMN-ND-10 | 10 | M4 | 20 | 7 | 24 | 11 |
| 502407 | RMN-ND-13 | 13 | M4 | 20 | 7 | 60 | 20 |
| 502409 | RMN-ND-16 | 16 | M4 | 20 | 7 | 90 | 30 |
| 502411 | RMN-ND-20 | 20 | M6 | 25 | 7 | 135 | 58 |
| 502413 | RMN-ND-25 | 25 | M6 | 35 | 9 | 190 | 131 |
| 502415 | RMN-ND-32 | 32 | M8 | 40 | 9 | 340 | 243 |
| 502417 | RMN-ND-40 | 40 | M8 | 50 | 9 | 700 | 480 |
| 502419 | RMN-ND-50 | 50 | M10 | 60 | 12 | 1000 | 904 |
| 502421 | RMN-ND-63 | 63 | M12 | 65 | 14 | 1700 | 1555 |

* The values of the nominal adhesive forces are approximate and refer to magnetic properties observed on laboratory samples.

