

THIS DRAWING CONTAINS INFORMATION PROPRIETARY TO RF INDUSTRIES,
 ANY UNAUTHORIZED USE OF THIS DRAWING IS EXPRESSLY PROHIBITED
 WITHOUT WRITTEN PERMISSION FROM RF INDUSTRIES.
 ANY VIOLATION IS PUNISHABLE UNDER U.S. COPYRIGHT LAWS.

PART NO.

RMX-9060-1B

REV	DESCRIPTION	DWN	DATE	APPROVED
-	ENGINEERING RELEASE	CZS	6/22/02	JDMc
A	UPDATED DWG. FORMAT & SPECS	CZS	05/27/03	JDMc

ALL DIMENSIONS ARE REFERENCE ONLY

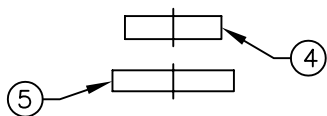
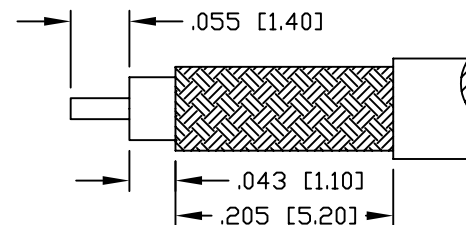
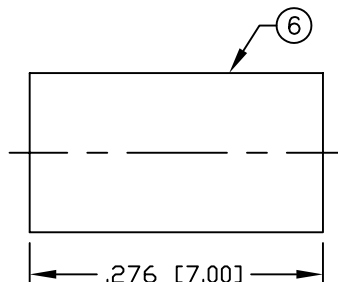
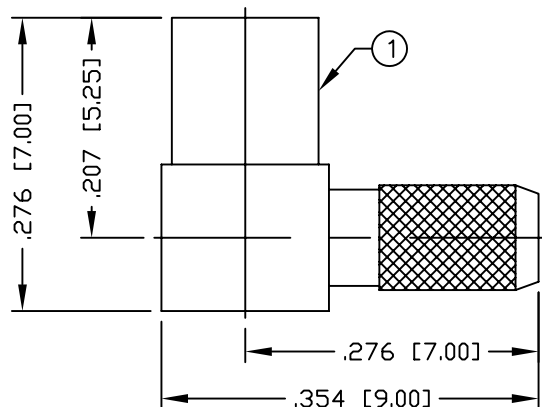

RECOMMENDED CRIMP DIE: .130"

RECOMMENDED STRIPPING DIMENSIONS

NOTE: ATTACH CABLE TO CONNECTOR BY SOLDERING
 THE CABLE INNER CONDUCTOR TO THE
 CONTACT SLOT INSIDE THE CONNECTOR

SPECIFICATIONS:

IMPEDANCE: 50 Ohms
 FREQUENCY RANGE: 0-6 GHz
 WORKING VOLTAGE: 170 V rms @ sea level
 TEMPERATURE RANGE: -65°C TO 165°C
 INSULATION RESISTANCE: 1k M Ohms min.
 FOR RG-174, 188, 188A, 316/U, ALPHA 9174, 9316,
 BELDEN 8216, 83269, 83284, 84316 & TIMES LMR-100A CABLE

14					
13					
12					
11					
10					
9					
8					
7					
6	FERRULE	1	COPPER	GOLD, 3μ"	
5	COVER	1	BRASS	GOLD, 3μ"	
4	INSULATOR	1	PTFE	---	
3	CONTACT	1	Be.Cu.	GOLD, 30μ"	
2	INSULATOR	1	PTFE	---	
1	BODY	1	BRASS	GOLD, 3μ"	
#	DESCRIPTION	QTY	MATERIAL	FINISH	APPROVALS

008974	
DRAWN	01/21/08
C. ZUNIGA	CHECKED
ORJ DRAWN	07/02/02
C. ZUNIGA	
APPROVALS	DATE

RoHS COMPLIANT

DIMENSIONS ARE IN INCHES AND [MILLIMETERS]
 UNLESS OTHERWISE NOTED TOLERANCES ARE:
 DECIMALS | DIAMETER

RF connectors
 DIVISION OF RF INDUSTRIES, LTD.

7610 MIRAMAR RD
 SAN DIEGO, CA 92126
 (858) 549-6340
 (858) 549-6345 FAX

MMCX JACK, CRIMP
 RIGHT ANGLE

SIZE A	CABLE GROUP B	DWG NO. RMX-9060-1B	REV A
SCALE: NTS		CAD FILE OUTLINE	SHEET 1 OF 1