

REVISIONS					
P	LTR	DESCRIPTION	DATE	DWN	APVD
B		REVISED PER ECR-20-100642	19SEP2022	M.G	D.Z

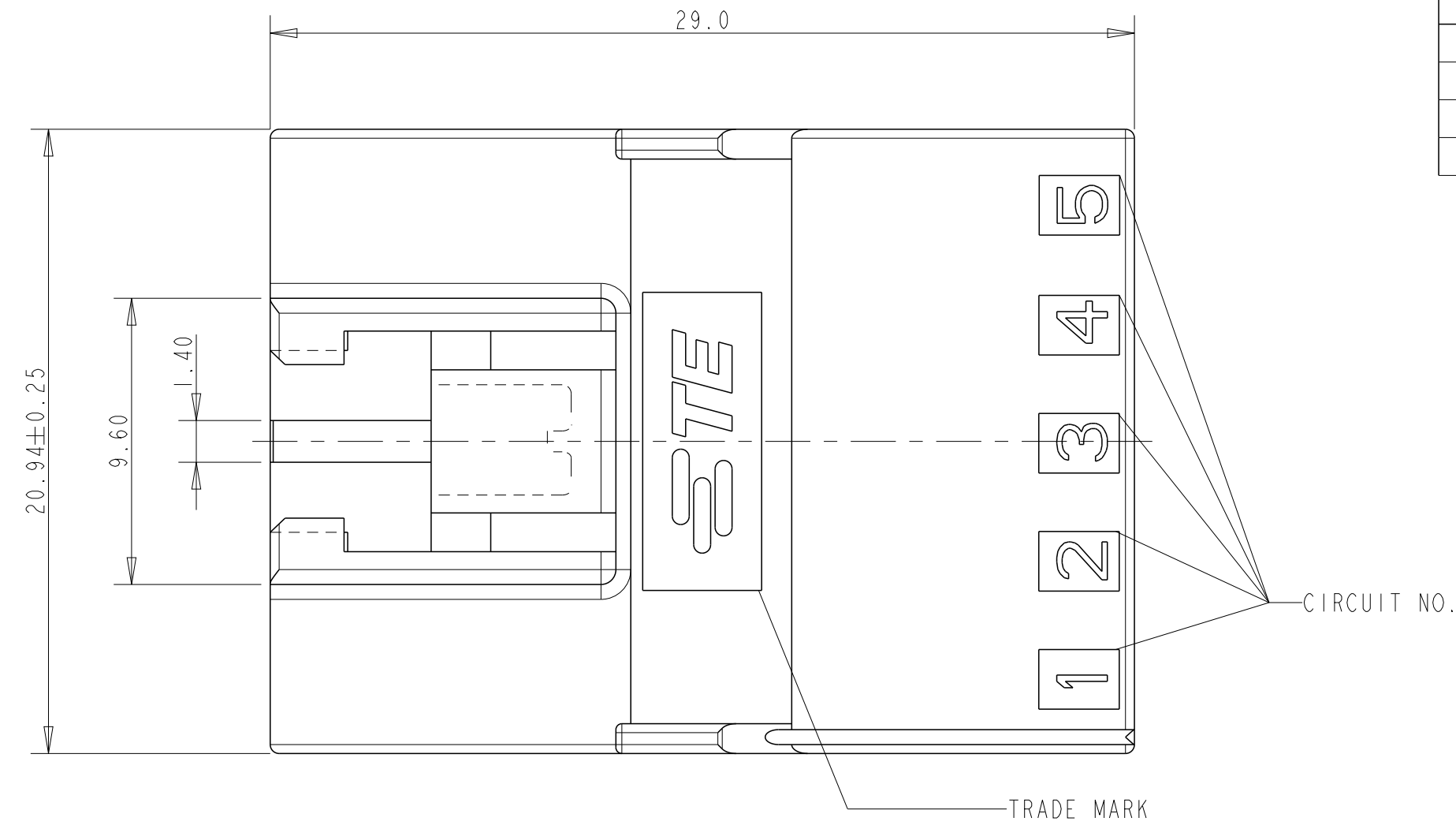

NOTES:

- APPLICABLE CONTACT P/N:  
 TAB CONTACT: 175150- (20-16 AWG)  
 175149- (26-22 AWG)
- MATING CONN. P/N:  
 PLUG HSG: 176279-  
 REC HSG: 175152- (20-16 AWG)  
 175151- (26-22 AWG)
- INSTRUCTION SHEET: IS-503J.

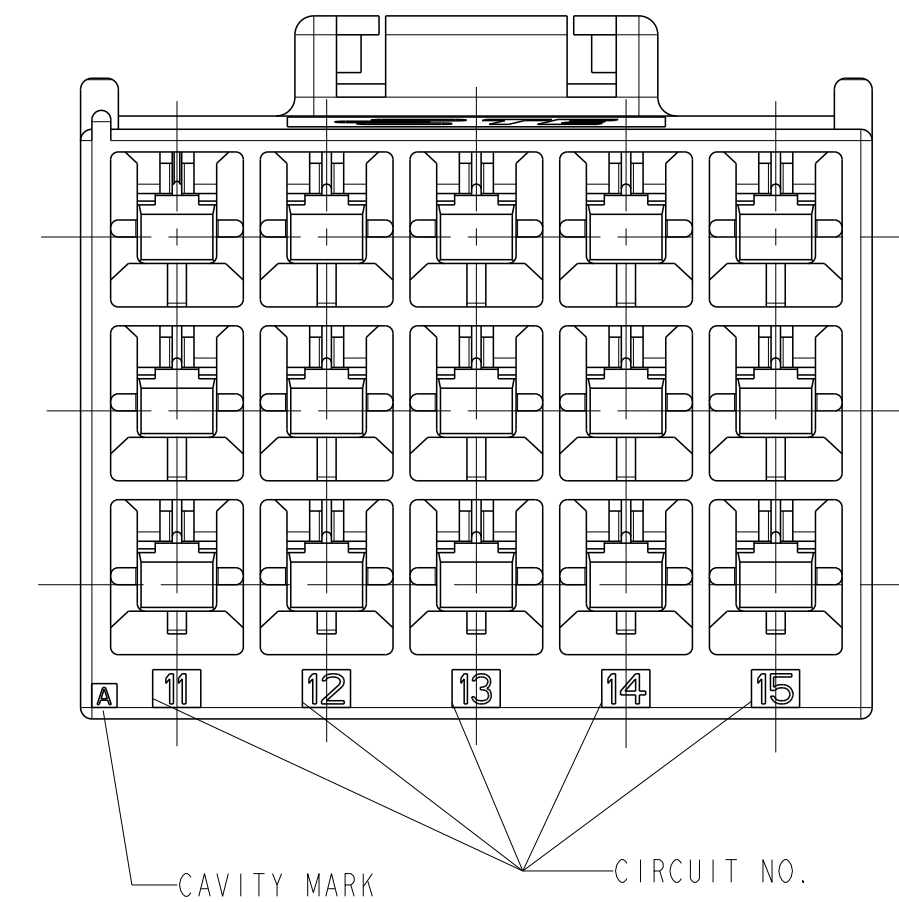
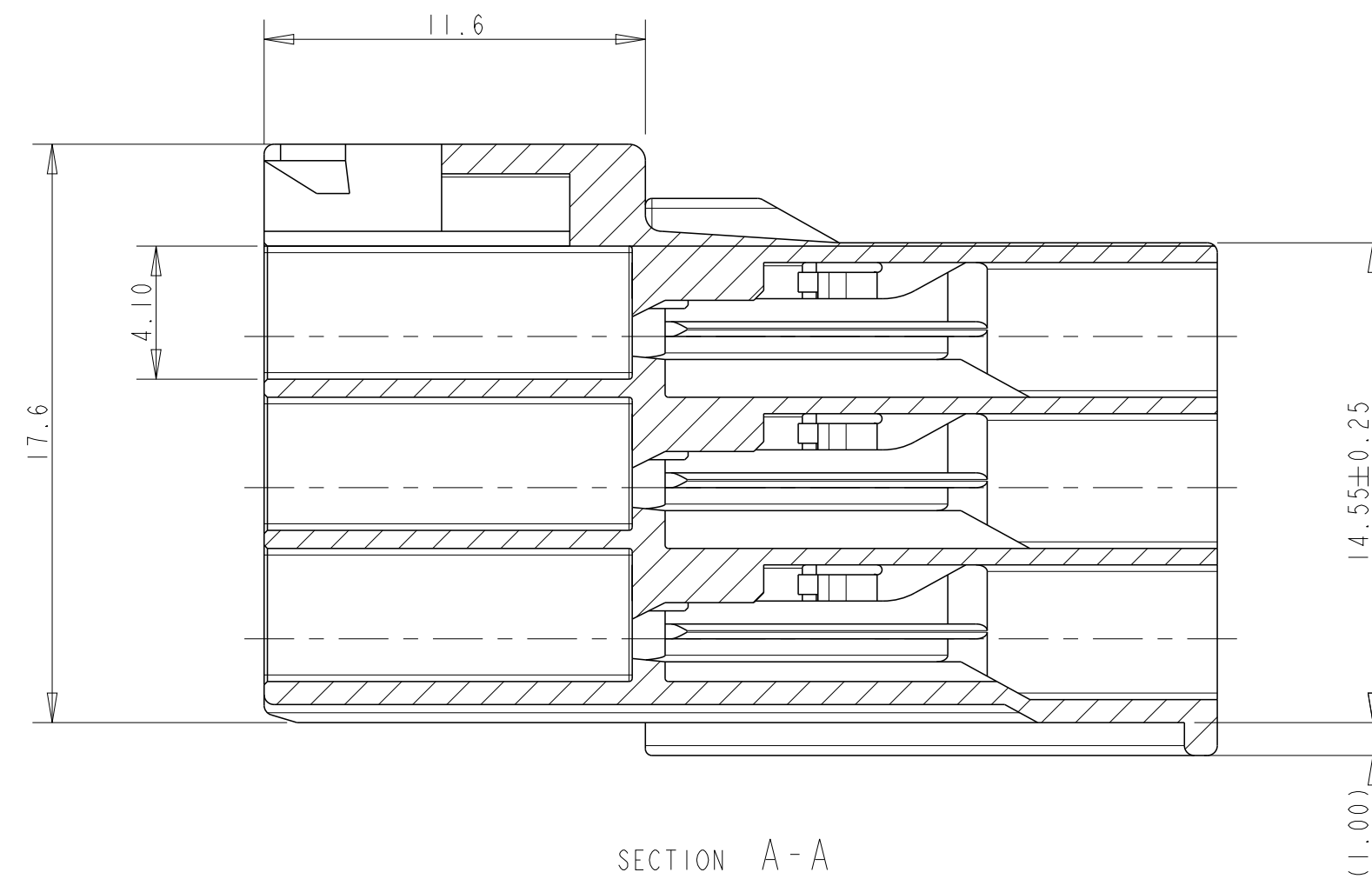
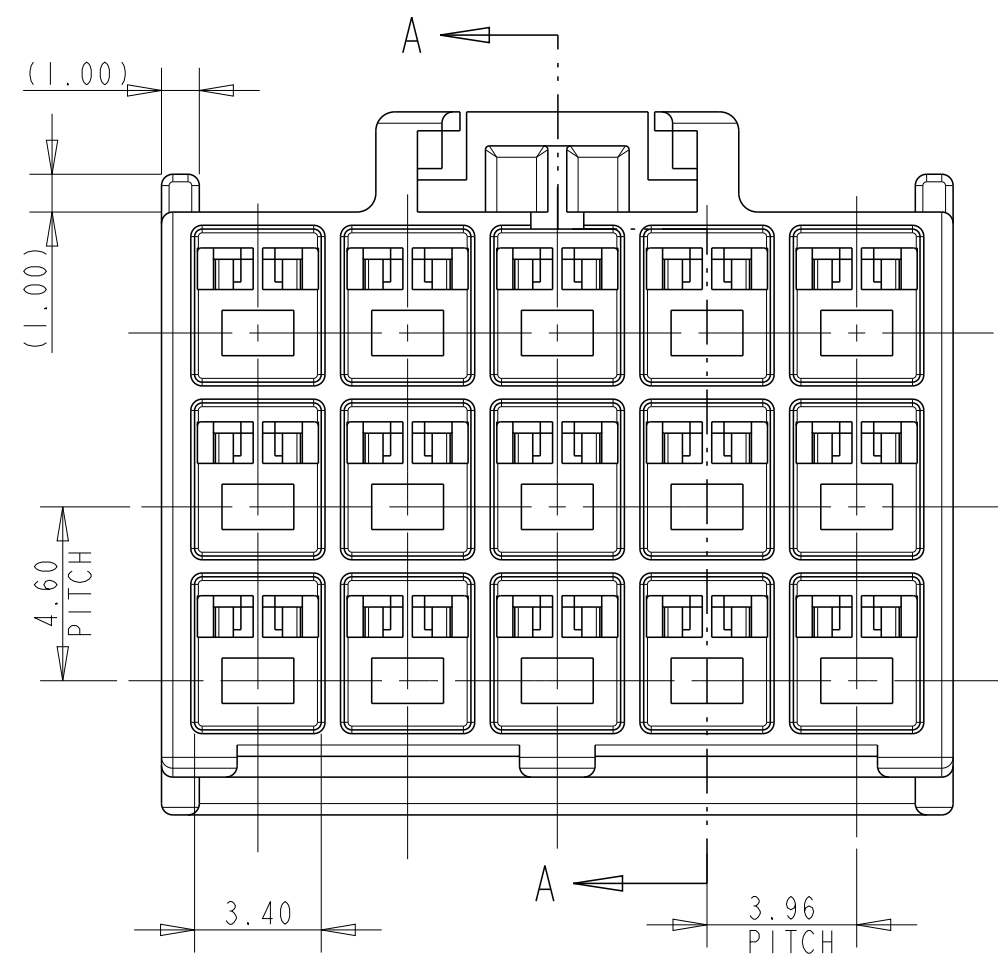

DISCONTINUED	HOUSING COLOR	POSITION	PART NUMBER
DEVELOPMENT	BLACK	15	176290-9
DEVELOPMENT	BLUE	15	176290-6
DEVELOPMENT	YELLOW	15	176290-4
DISCONTINUED	RED	15	176290-2
	NATURAL	15	176290-1

THIS DRAWING IS A CONTROLLED DOCUMENT.		DWN M. SHINDO 23NOV1989	TE Connectivity															
DIMENSIONS: mm		CHK M. YOSHIDA 28NOV1989																
TOLERANCES UNLESS OTHERWISE SPECIFIED:		APVD N. ONQUE 28NOV1989	NAME AMP UNIVERSAL POWER CONN, 3.96mm PITCH CAP HOUSING 15 Pos (TPL ROW)															
<table border="1"> <tr> <td>0 PLC</td> <td>±</td> </tr> <tr> <td>1 PLC</td> <td>±0.25</td> </tr> <tr> <td>2 PLC</td> <td>±0.2</td> </tr> <tr> <td>3 PLC</td> <td>±</td> </tr> <tr> <td>4 PLC</td> <td>±</td> </tr> <tr> <td>ANGLES</td> <td>±3°</td> </tr> <tr> <td>FINISH</td> <td>-</td> </tr> </table>		0 PLC	±	1 PLC	±0.25	2 PLC	±0.2	3 PLC	±	4 PLC	±	ANGLES	±3°	FINISH	-	PRODUCT SPEC 108-5302	SIZE A2	
0 PLC	±																	
1 PLC	±0.25																	
2 PLC	±0.2																	
3 PLC	±																	
4 PLC	±																	
ANGLES	±3°																	
FINISH	-																	
MATERIAL 6/6 NYLON (UL94 V-0)		APPLICATION SPEC 114-5142	CAGE CODE 00779	DRAWING NO C-176290														
		WEIGHT -	RESTRICTED TO -															
		CUSTOMER DRAWING	SCALE 5:1	SHEET 1 OF 1														
			REV B															