

APPROVED: _____
 DATE: _____ TITLE: _____

Rev	AWO #	Description	Date	Appr
-		RELEASED	1/26/21	

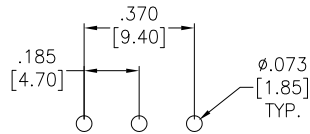
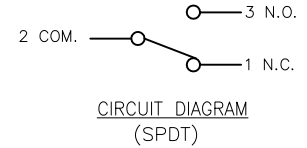
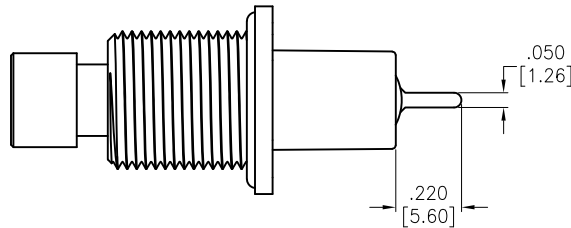
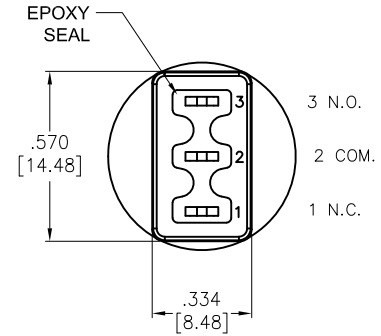
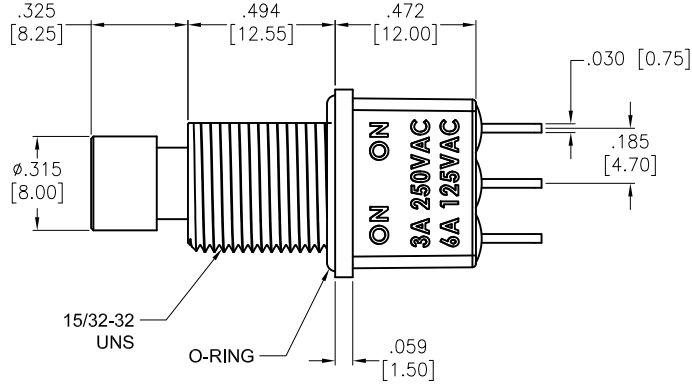
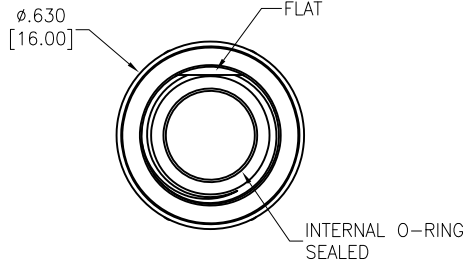

RECOMMENDED PCB LAYOUT

BUTTON POSITION		
FUNCTION	ON	ON
TERMINALS	2-3	2-1

SPECIFICATIONS:

Material:
 Case: DAP, Rated UL94V-0
 Plunger: Brass, color Black w/ O-Ring
 Bushing: Brass, color Black w/ O-Ring
 Movable Contact: Copper Alloy, Silver Plated
 Terminal: Copper Alloy, Silver Plated
 Electrical:
 Rating: 6A @ 125VAC or 28V DC
 3A @ 250VAC
 Contact resistance: 10 mΩ max
 Insulation resistance: 1,000 Mohms min
 Dielectric withstanding voltage: 1,500V RMS @Sea level
 Life: 50,000 cycles at full load
 Temperature Rating:
 Operating temperature: -30°C to +85°C
 Environmental:
 Sealed IP68 Rated
 Lead free, RoHS compliant



UNLESS OTHERWISE SPECIFIED ALL DIMENSIONS ARE INCHES [MM] TOLERANCES: EXCEPT AS NOTED			
INCHES		HOLES	
.X	± .10	Ø.X	± .10
.XX	± .020	Ø.XX	± .015
.XXX	± .015	Ø.XXX	± .010
APPROVALS		DATE	
DRAWN	LH	1/26/21	
CHECKED	AC	1/26/21	
APPROVED			

ADAM TECH 909 Rahway Avenue,
 Union, NJ 07083
 Phone: 908-687-5000
 Fax: 908-687-5710

TITLE: HIGH PERFORMANCE PUSH BUTTON SWITCH,
 SPDT, ON-ON, SILVER PLATED, PCB TAILS

SIZE X	PART NO. SW-PB10-AAA2QE-4	REV. -
REF: S00198T	SCALE: NTS	SHEET 1 OF 1