

Recommended P.C. Board Layout
SCALE 4:1

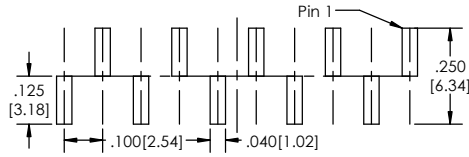

SINGLE (M) ROW

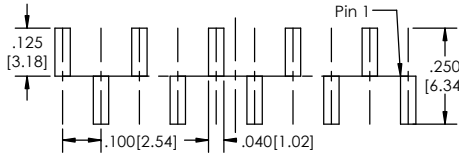

SINGLE (S) ROW

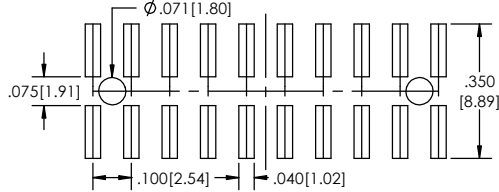

DOUBLE ROW

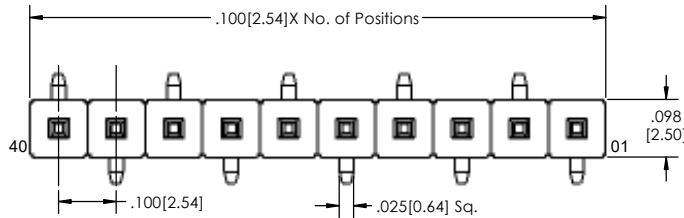

SINGLE (S) ROW

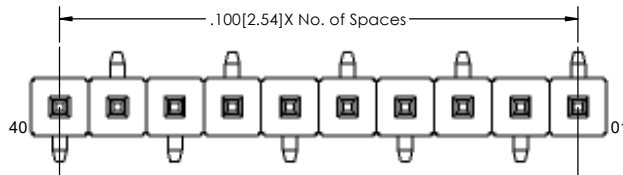

SINGLE (M) ROW

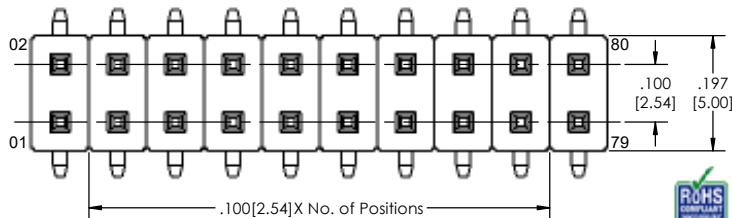

DOUBLE ROW

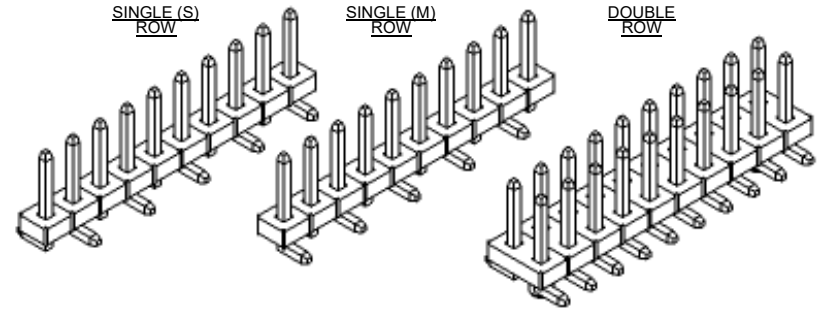
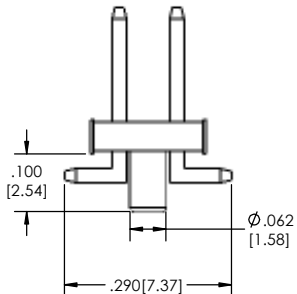
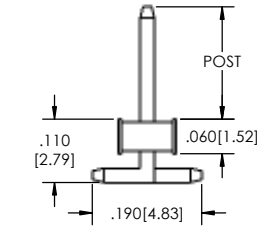

ULTSHSM-1 **XX** - **X** - **XX** - **XX** - **X** - **XXX** - **X** - **XX** - **X** - **XX** - **LF**
(A) **(B)** **(C)** **(D)** **(E)** **(F)** **(G)** **(H)** **(I)** **(J)** **(K)**

- A. Pins Per Row
- 1 through 40
- B. Row Specification
- S= Single
- D= Double
- C. Pin Options
- See Pin Options below
- D. Plating Options
- See Plating Options below
- E. Direction
- V= Vertical
- F. Polarized Position
- Leave blank if not needed
- If required, specify empty pin position
- e.g. 012 for Pin 12
- G. Footprint
- S= pin 1 left
- M= pin 1 right
- H. Packing Information
- TR= Tape and Reel
- TB= Tube
- I. Pad
- P= Plastic
- O= No Pad
- If left blank, packaging at MLE's discretion
Pad may be metal, mylar or plastic
- J. Alignment Pin Option
- Leave blank if not needed
- AP= With
- K. Lead Free

Mates with:
BCSS.
BSSH.
BSSH.C.
BSSQ.
BSSQ.C.
BSSQ.M.
LBCSS.
LSMBC.
LSWSS.
SMBC.
SSHQ.
SSHQ.R.
SSHR.
SSHS.
SSHSM.

Plating options	
G	-10µ Gold on Contact Area/ Flash on Tail
T	-Matte Tin all Over
GT	-10µ Gold on Contact Area/ Matte Tin on Tail
H	-30µ Gold on Contact Area/ Matte Tin on Tail
F	-Gold Flash over Entire Pin
FT	- Gold Flash on Contact Area/ Matte Tin on Tail

Specifications:
 Current Rating: 3.0 Ampere
 Insulation Resistance: 1000M Ohms Min.
 Dielectric Withstanding: 600V AC
 Contact Resistance: 20M Ohms Max.
 Operation Temperature: -40°C to +105°C
 Max. Process Temperature
 Peak: 260°C up to 20 secs.
 Process: 230°C up to 60 secs.
 Wave: 260°C up to 6 secs.
 Reflow: 260°C up to 10 secs.
 Manual Solder: 350°C up to 5 secs.

Pin Options	
Post Height	
.120	3.05mm 01
.140	3.56mm 02
.175	4.45mm 03
.270	6.86mm 06

Materials:
 Contact Material: Phosphor Bronze
 Insulator Material: Nylon 6T
 Plating: Au or Sn over 50µ" (1.27) Ni
 Tails may be clipped to achieve specific dimensions.
 Products cut to specific sizes are uncancelable/ nonreturnable.
 Parts are subject to change without notice.



PROPRIETARY AND CONFIDENTIAL
 THE INFORMATION CONTAINED IN THIS DRAWING IS THE SOLE PROPERTY OF Major League Electronics. ANY REPRODUCTION IN PART OR AS A WHOLE WITHOUT THE WRITTEN PERMISSION OF Major League Electronics IS PROHIBITED.

UNLESS OTHERWISE SPECIFIED:		DRAWN: EOW 07/05/16		NAME: DATE:	
DIMENSIONS ARE IN INCHES		CHECKED: GWE 07/05/16		ADDRESS: 2533 Centennial Blvd. Jeffersonville, In 47130	
TOLERANCES: ONE DECIMALS ±.100 TWO DECIMALS ±.010 THREE DECIMALS ±.005 FOUR DECIMAL ±.002		ENG APPR:		Phone: 812-670-4174	
NEXT ASSY USED ON:		MFG APPR:		Fax: 812-670-4175	
APPLICATION		FINISH		E-Mail: mle@mlelectronics.com	
DO NOT SCALE DRAWING		TITLE: ULTSHSM-1 SERIES		SCALE 6:1	
		SIZE DWG. NO. C		REV C	
		SHEET 1 OF 1			