

L101374SP Series

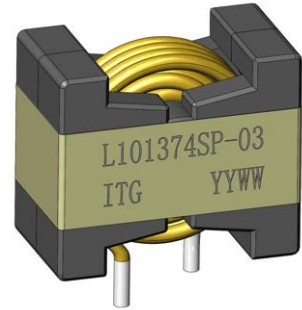

1. Features of L101374SP Series :

- Ferrite-Based Resonant Inductors.
- Inductance range:15.0uH to 56.0uH, Custom values are welcomed.
- High current output chokes, up to 71.0 Amp with approx. 30% roll off.
- Dielectric strength:1500Vrms,winding to core.
- Operating Temperature Range -55 °C to +130 °C, RoHs & HF compliance.



2. Electrical Characteristic of L101374SP Series:

ITG Part Number	OCL ¹	DCR ²	Isat1 ³	Isat2 ⁴	Isat3 ⁴	Isat4 ⁴	Irms ⁵
	(uH) ± 10%	(mΩ) Max.	(A) @25°C	(A) @25°C	(A) @75°C	(A) @100°C	(A) @25°C
L101374SP-03	15.00	12.00	45.00	49.00	43.00	39.50	18.00
L101374SP-04	18.00	12.00	37.00	40.50	35.50	32.50	18.00
L101374SP-05	22.00	12.00	30.00	33.00	29.00	26.50	18.00
L101374SP-06	33.00	12.00	19.00	21.50	18.50	17.00	18.00
L101374SP-13	15.00	15.00	65.00	71.00	60.00	56.00	17.00
L101374SP-14	18.00	15.00	55.00	58.50	51.00	47.00	17.00
L101374SP-15	22.00	15.00	43.00	45.50	39.00	37.00	17.00
L101374SP-16	33.00	15.00	28.00	30.50	26.00	24.00	17.00
L101374SP-17	56.00	15.00	16.00	17.00	15.00	14.00	17.00
L101374SP-23	15.00	6.00	45.00	48.00	42.00	38.50	28.00
L101374SP-24	18.00	6.00	37.00	40.00	35.00	32.00	28.00
L101374SP-25	22.00	6.00	30.00	32.50	28.50	26.50	28.00
L101374SP-26	33.00	6.00	19.00	20.50	18.00	16.50	28.00

Notes:

1. Open Circuit Inductance (OCL) test condition: 100KHz,0.25Vrms,0A_{dc} ,at 25 °C.
2. DCR test conditions: Ta=25°C.
3. Isat1 : DC current that will cause inductance to drop approximately by 20%.
4. Isat2,Isat3 & Isat4 : DC current that will cause inductance to drop approximately by 30%.
5. Irms : DC current for an approximate temperature rise of 40°C without core loss , Derating is necessary for AC currents.
PCB pad layout , trace thickness and width , air-flow and proximity of other heat generating components will affect the temperature rise. It is recommended the part temperature not exceed 130 °C under worst case operating conditions verified in the end application.

3. Mechanical Dimension(Unit : mm):

ITG Part Number	A	B	C	D	E1	E2	F	PCB Layout Fig.
	Max.	Max.	Max.	± 1.00	Typ.	Typ.	Max.	
L101374SP-03	33.50	18.50	28.00	6.00	12.00	8.50	2.50	1
L101374SP-04	33.50	18.50	28.00	6.00	12.00	8.50	2.50	1
L101374SP-05	33.50	18.50	28.00	6.00	12.00	8.50	2.50	1
L101374SP-06	33.50	18.50	28.00	6.00	12.00	8.50	2.50	1
L101374SP-13	33.50	21.00	28.00	6.00	12.00	10.00	2.50	2
L101374SP-14	33.50	21.00	28.00 <td 6.00	12.00	10.00	2.50	2	
L101374SP-15	33.50	21.00	28.00	6.00	12.00	10.00	2.50	2
L101374SP-16	33.50	21.00	28.00	6.00	12.00	10.00	2.50	2
L101374SP-17	33.50	21.00	28.00	6.00	12.00	10.00	2.50	2
L101374SP-23	33.50	30.50	28.00	6.00	12.00	17.00	3.50	3
L101374SP-24	33.50	30.50	28.00	6.00	12.00	17.00	3.50	3
L101374SP-25	33.50	30.50	28.00	6.00	12.00	17.00	3.50	3
L101374SP-26	33.50	30.50	28.00	6.00	12.00	17.00	3.50	3

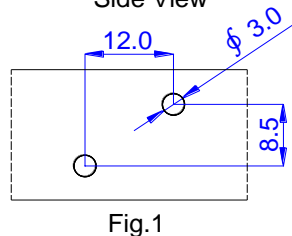
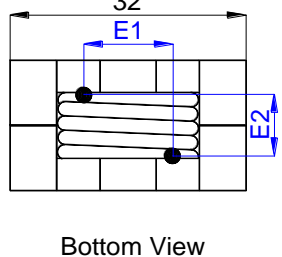
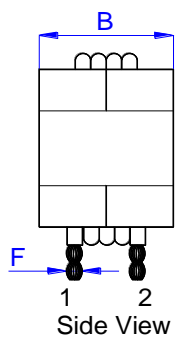
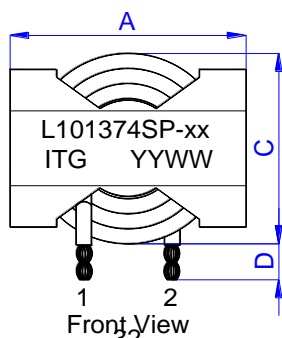

Fig.1

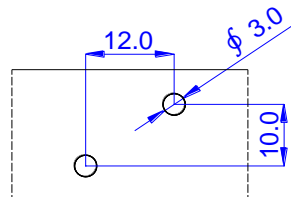

Fig.2

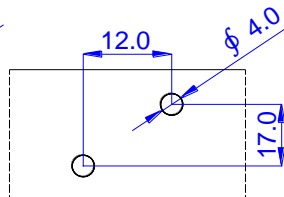

Fig.3

Suggest PCB Layout

Part Marking:

L101374SP-xx: Part Number.

ITGYYWW:ITG is Company Name,YYWW is Date Code

Third Angle Projection:

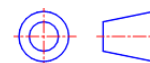

● New York 1 914 347 2474 ● Taipei 886 2 2698 8669 ● Kaohsiung 886 7 350 2275

● Japan 81 568 85 2830 ● Shenzhen 86 755 8418 6263 ● Shanghai 86 21 5424 5141 ● Hong Kong 852 9688 9767

● sales@ITG-Electronics.com ● www.ITG-Electronics.com Revision A.0: Sep. 28, 2022

*Due to continuous product improvement, all specifications are subject to change without prior notice. Kindly contact an ITG field application engineer or a sales representative prior to purchase.



L101374SP Series



Halogen Free

4. Inductance Characteristics (Inductance vs Current):

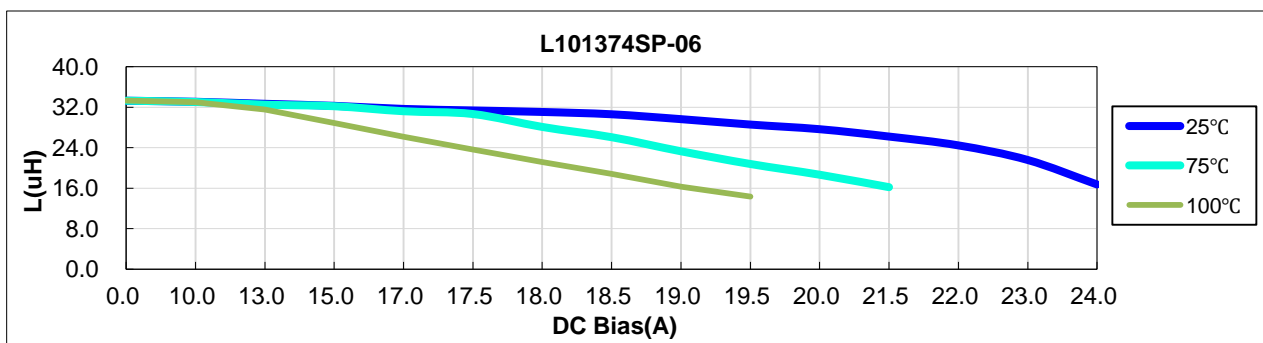
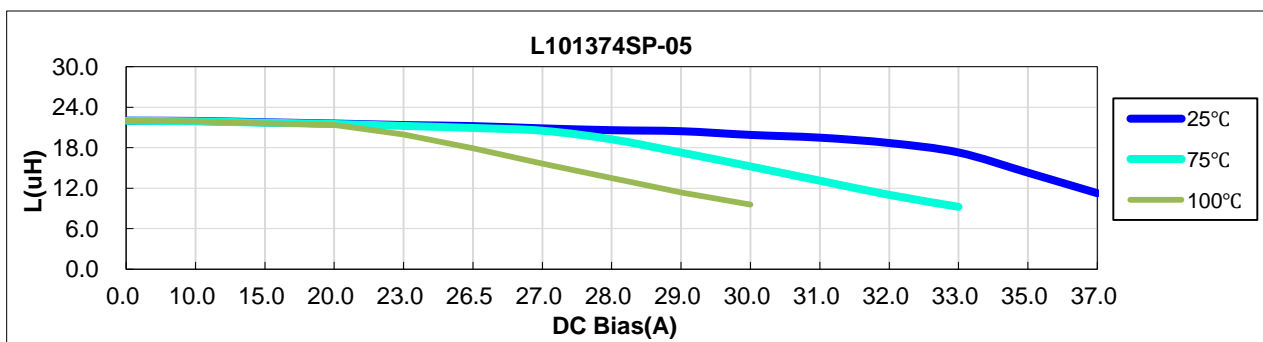
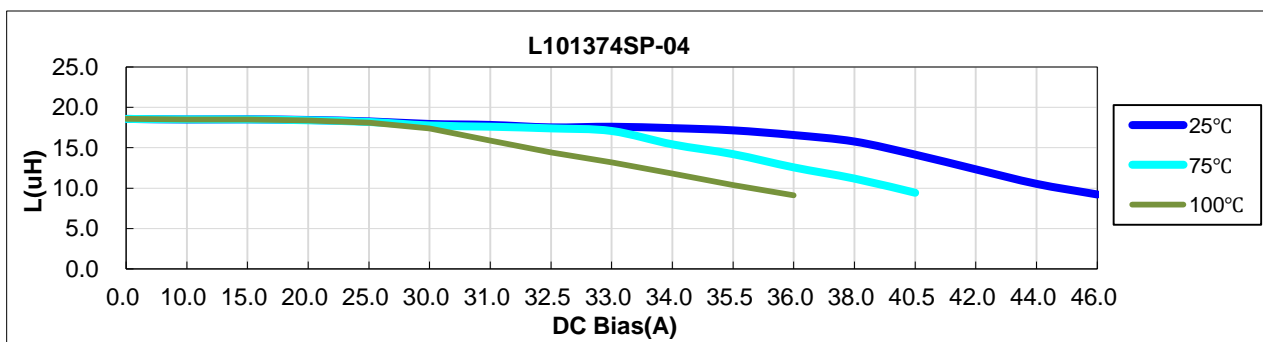
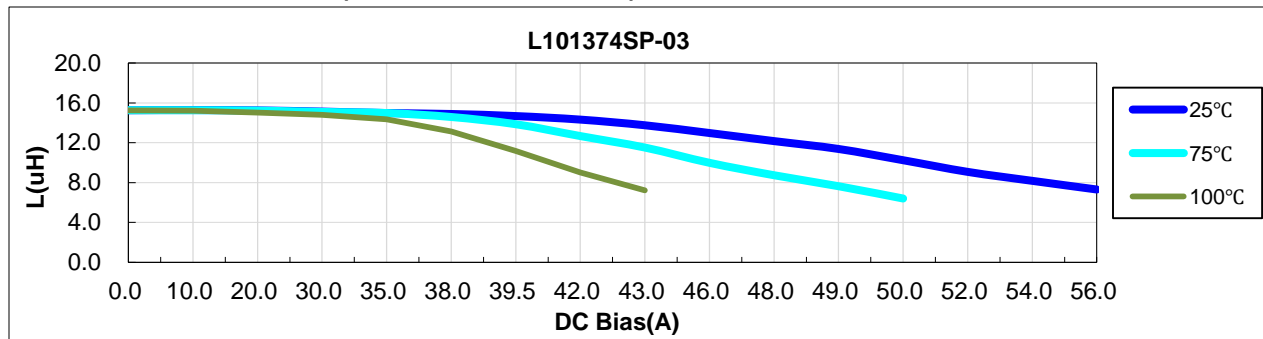

*Due to continuous product improvement, all specifications are subject to change without prior notice. Kindly contact an ITG field application engineer or a sales representative prior to purchase.



Halogen Free

L101374SP Series



4. Inductance Characteristics (Inductance vs Current):

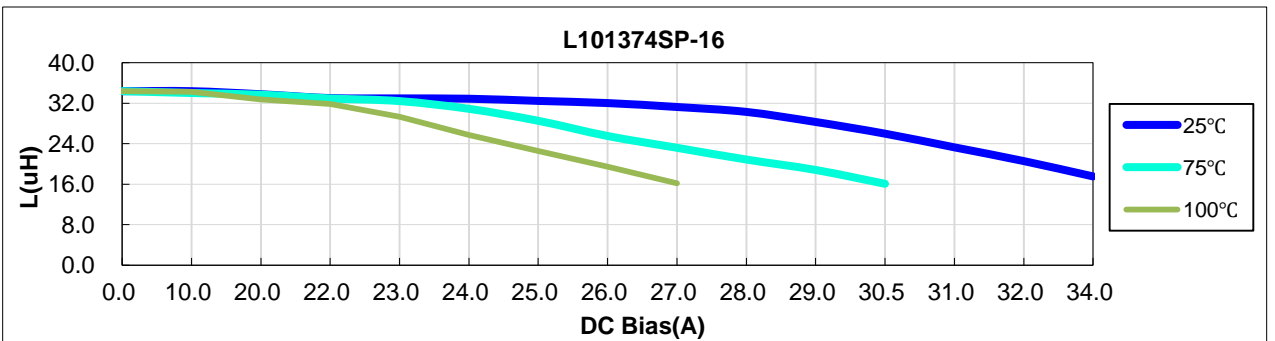
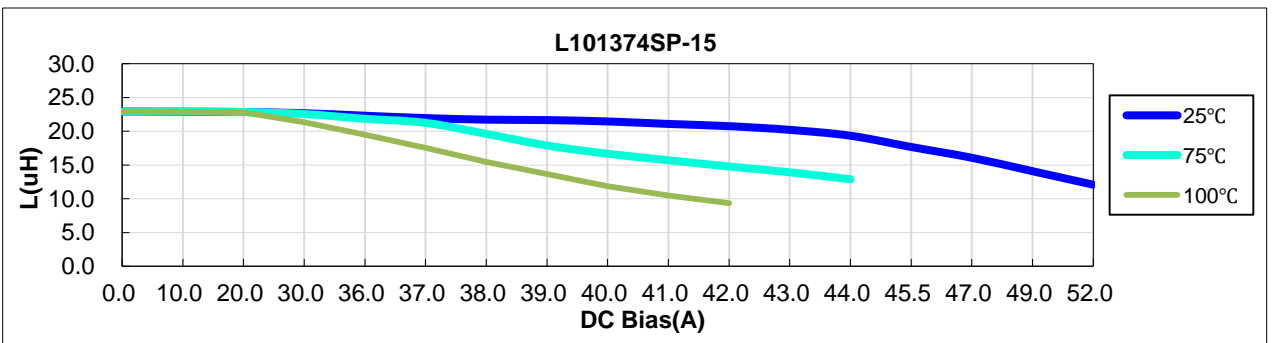
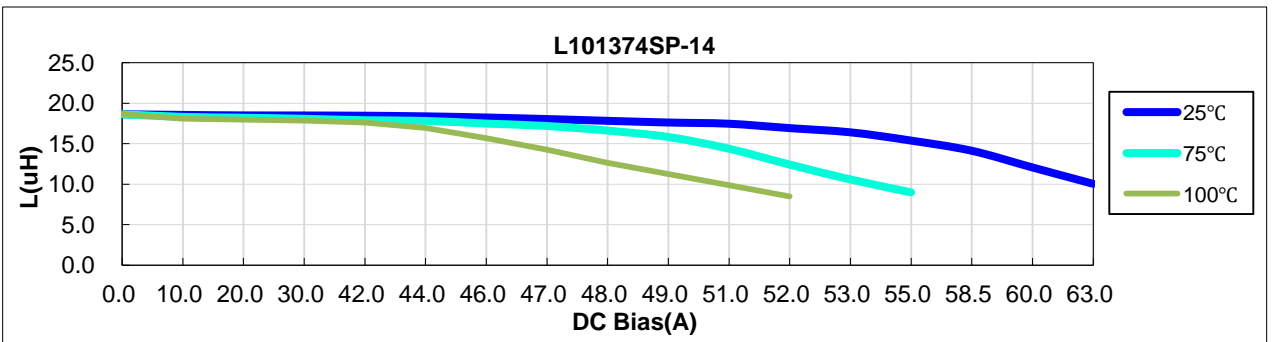
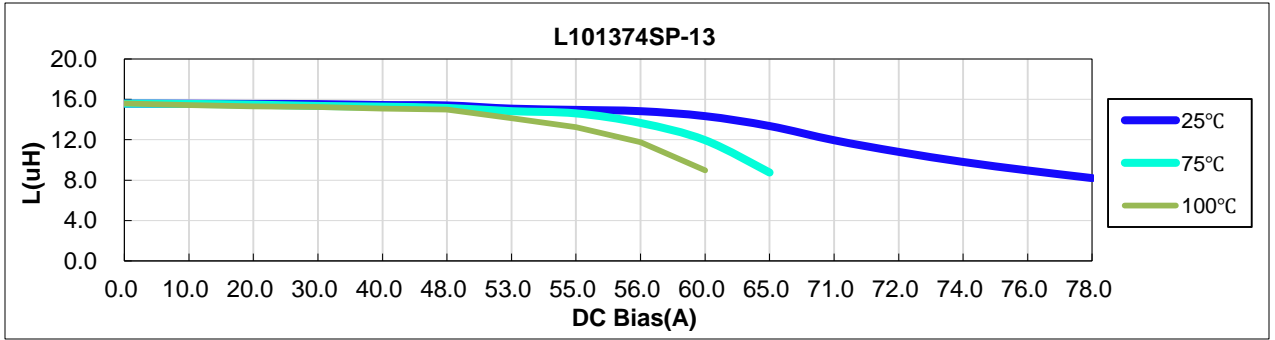

*Due to continuous product improvement, all specifications are subject to change without prior notice. Kindly contact an ITG field application engineer or a sales representative prior to purchase.



L101374SP Series



Halogen Free

4. Inductance Characteristics (Inductance vs Current):

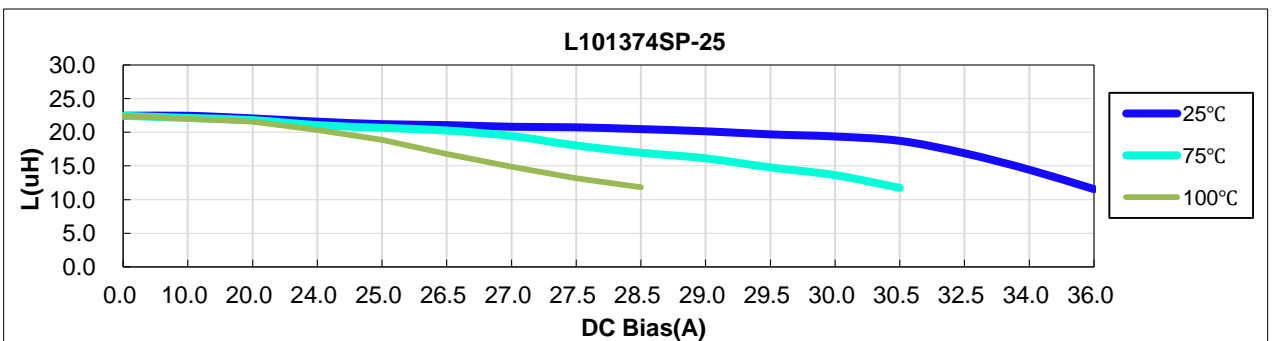
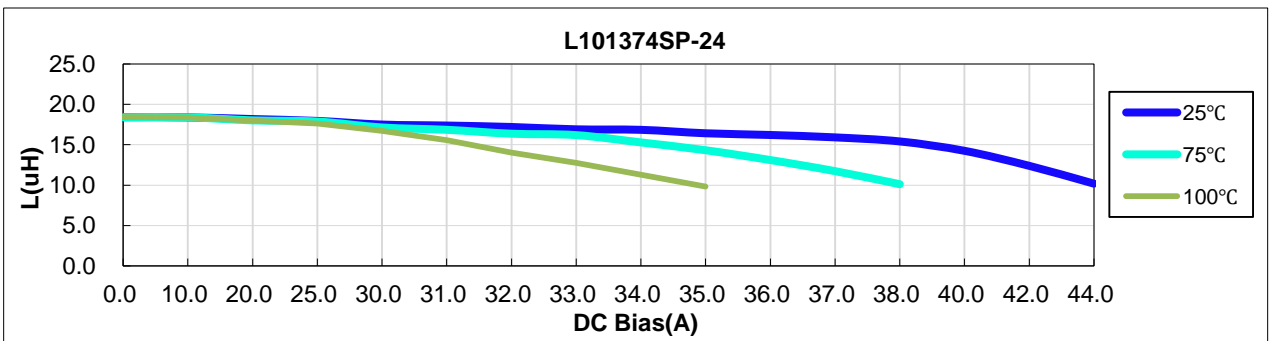
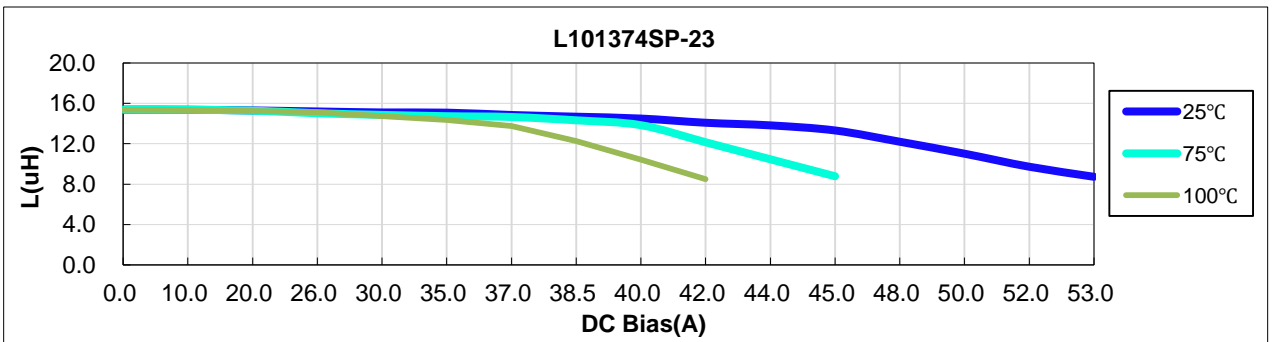
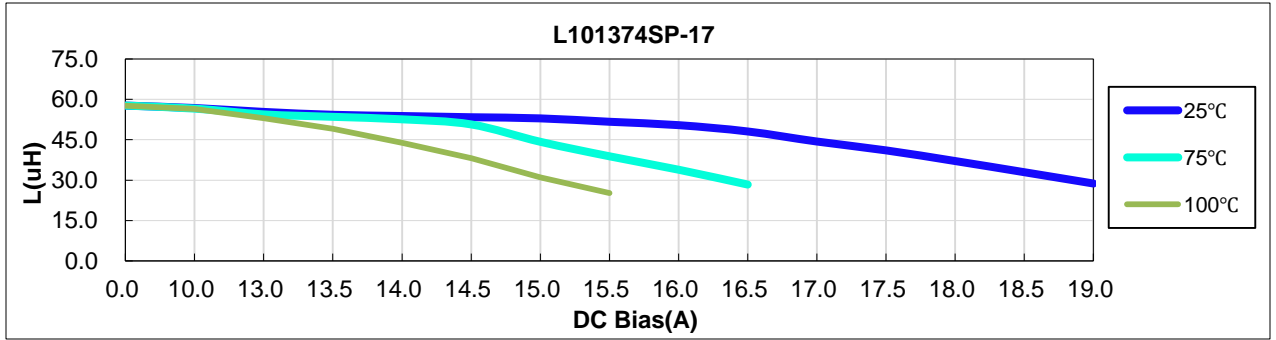

*Due to continuous product improvement, all specifications are subject to change without prior notice. Kindly contact an ITG field application engineer or a sales representative prior to purchase.



Halogen Free

L101374SP Series



4. Inductance Characteristics (Inductance vs Current):

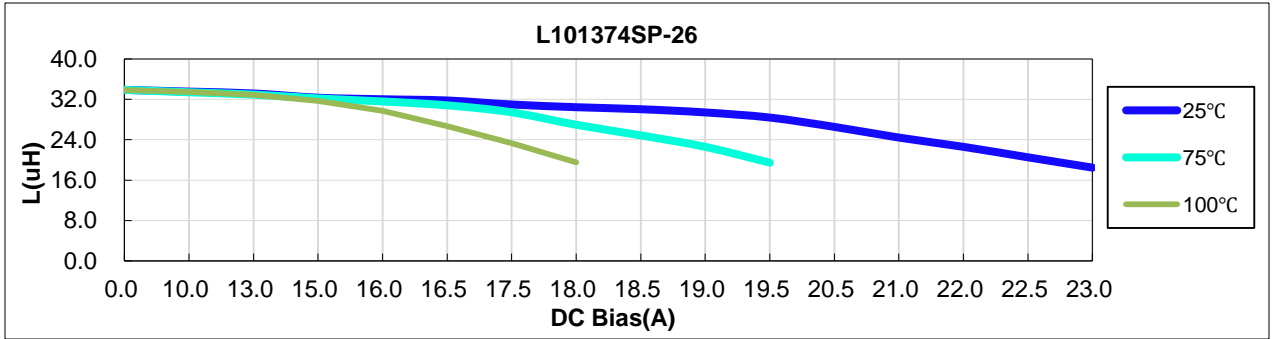

**Due to continuous product improvement, all specifications are subject to change without prior notice. Kindly contact an ITG field application engineer or a sales representative prior to purchase.*