

6

5

4

3

2

1

APPROVED: \_\_\_\_\_

DATE: \_\_\_\_\_ TITLE: \_\_\_\_\_

Rev	AWO #	Description	Date	Appr
-		RELEASED	8/16/21	

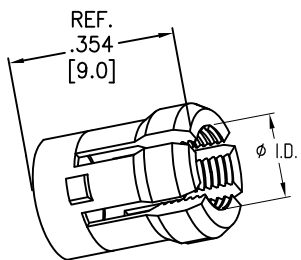

CABLE COLLET

MMI-POM-COL-XX

CABLE COLLET SIZE	
32	= 2.2mm ~ 3.2mm ID
42	= 3.2mm ~ 4.2mm ID
45	= 3.5mm ~ 4.5mm ID
52	= 4.2mm ~ 5.2mm ID
55	= 4.5mm ~ 5.5mm ID

D

D

C

C

B

B

A

A

SPECIFICATIONS:

Material:  
 Brass, Natural Chrome plated  
 Environmental:  
 Lead free, RoHS compliant



UNLESS OTHERWISE SPECIFIED ALL DIMENSIONS ARE INCHES [MM] TOLERANCES: EXCEPT AS NOTED		
INCHES HOLES		
.X	± .10	Ø.X ± .10
.XX	± .020	Ø.XX ± .015
.XXX	± .015	Ø.XXX ± .010
APPROVALS		DATE
DRAWN	SS	8/16/21
CHECKED	SS	8/16/21
APPROVED		

**ADAM TECH** 909 Rahway Avenue,  
 Union, NJ 07083  
 Phone: 908-687-5000  
 Fax: 908-687-5710

TITLE PUSH-PULL METAL COLLET FOR MALE METAL PLUG SIZE 0, IP50			
SIZE X	PART NO. MMI-POM-COL-XX	REV. -	
REF: SXXXXX	SCALE: NTS	SHEET 1 OF 1	

6

5

4

3

2

1