

REVISIONS					
P	LTN	DESCRIPTION	DATE	DWN	APVD
A11		REVISED PER ECO-10-020914	22NOV2010	DLD	DCM
A12		REVISED PER ECO-20-012415	10SEP2020	AP	CM

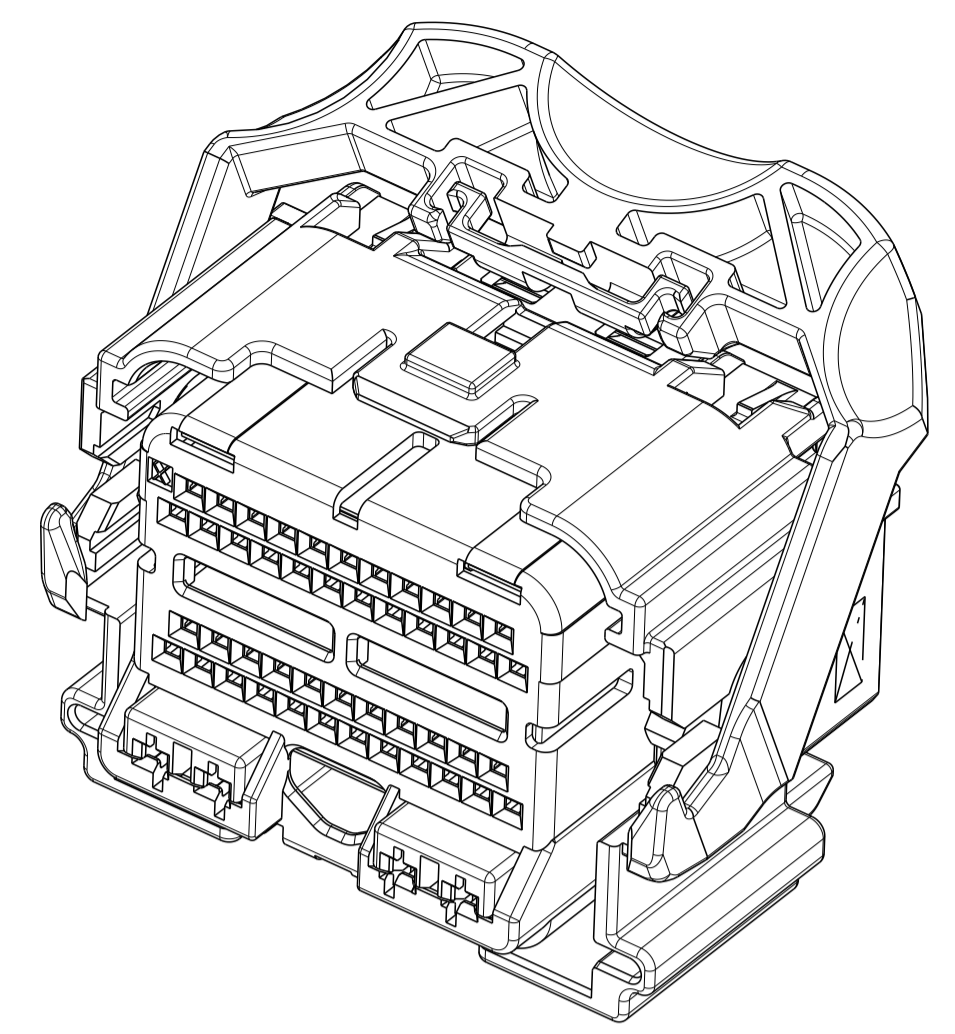

PART NUMBER:
1438693-1
SHOWN WITH SPACER
IN SEATED POSITION
SCALE 2:1

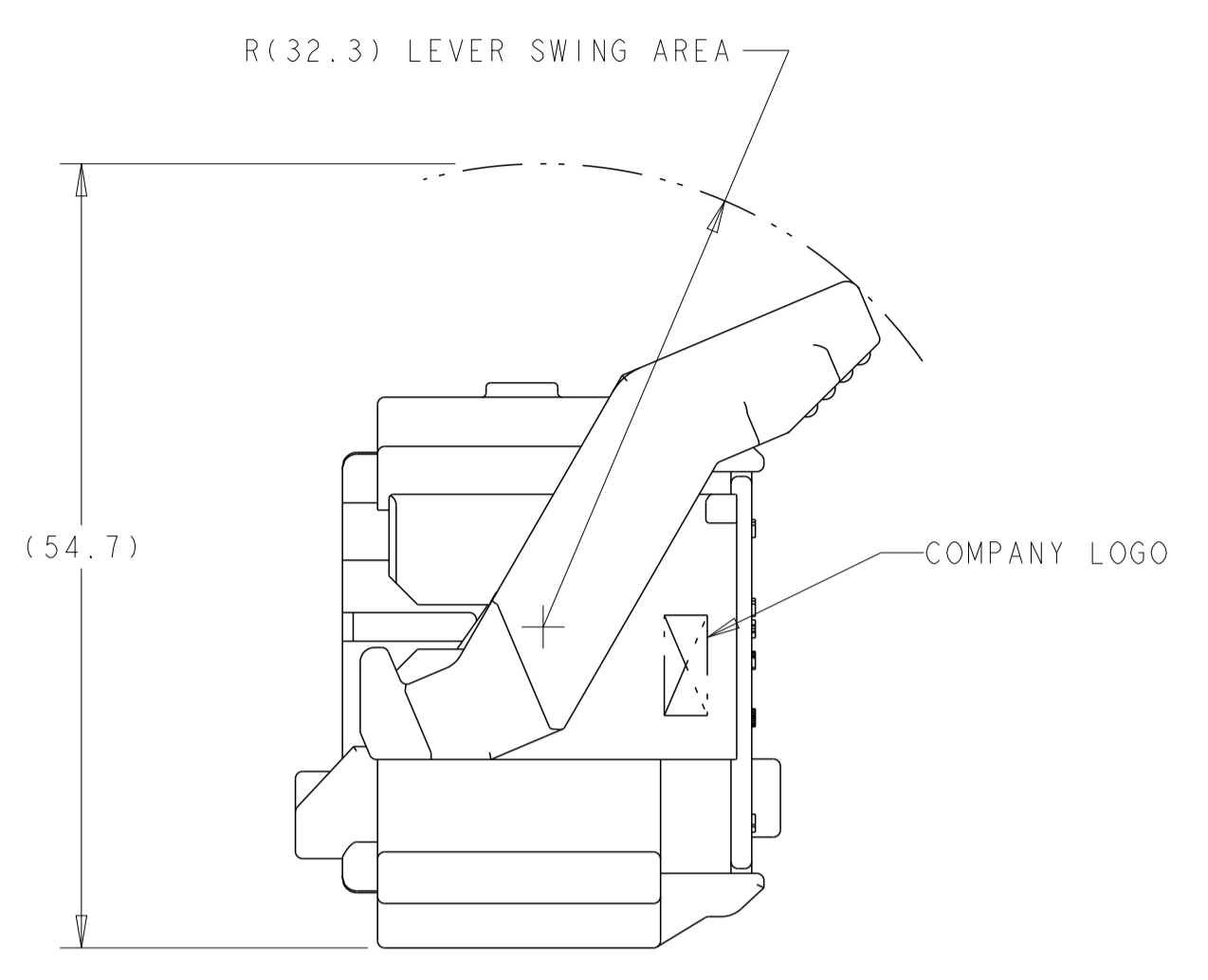
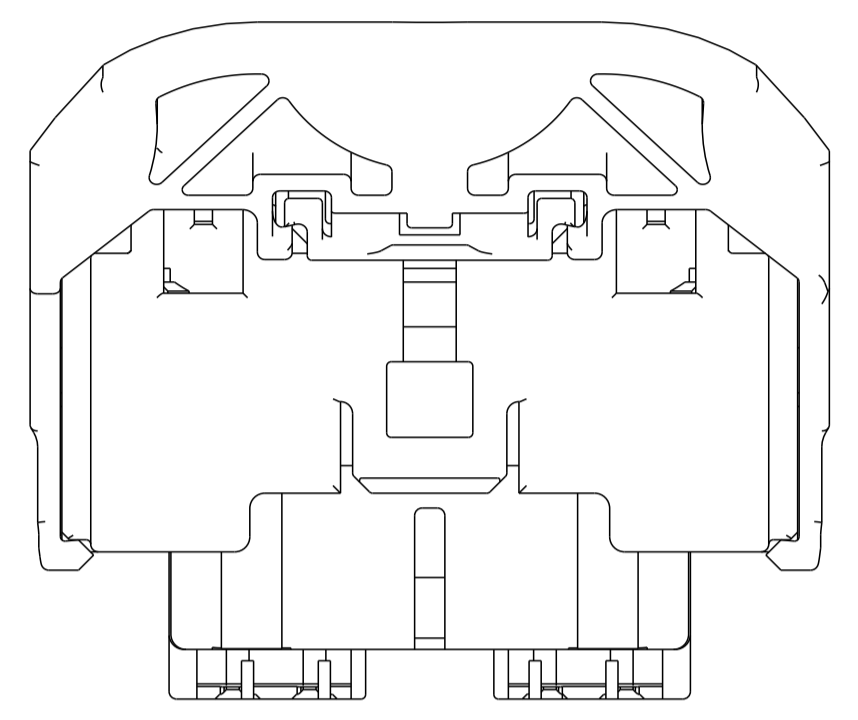

SHOWN WITH SPACER IN SEATED POSITION

- △ PRINT TYCO ELECTRONICS PART NUMBER AND TRACEABILITY (YY : 2 DIGIT YEAR, JJJ = JULIAN DATE, HH = 2 DIGIT MILITARY HOUR CODE) IN THE LOCATION AT ASSEMBLY.
- △ OPTIONAL WIRE SHIELD PART NUMBERS (SOLD SEPARATELY) 1438126, 1438180, 1488373, AND 1488572. CONTACT TYCO ELECTRONICS ENGINEER FOR MINIMUM FEED THRU CONDITION.
- 3. APPLICABLE TERMINAL PART NUMBERS (SOLD SEPARATELY)
FOR TIN APPLICATIONS: 1393367 AND 1393366.
FOR GOLD APPLICATIONS: 1393365 AND 1393364
FOR TERMINATION AND REELING OPTIONS SEE DRAWINGS 1393367, 1393366, 1393365, AND 1393364.
- 4. APPLICABLE MOLEX (1.5) POWER TERMINAL PART NUMBERS:
33012-0002 TIN 0.50-1.50mm²
- 5. CAM LEVER AND SPACER ARE SHIPPED IN THEIR PRE-ASSEMBLED POSITIONS.
- △ OBSOLETE PART

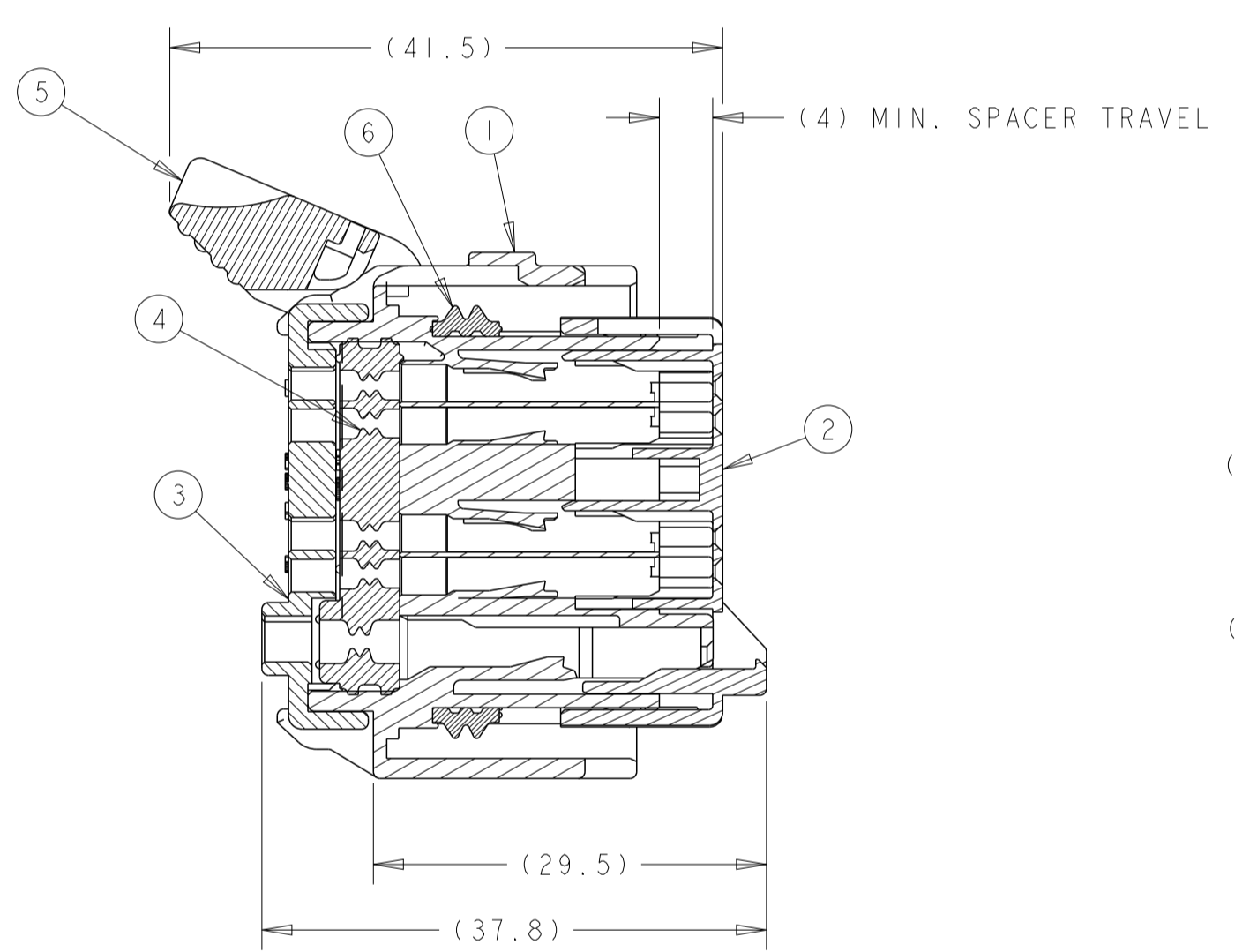

SECTION A-A
SPACER AND LEVER IN
PRE-SEATED POSITION
(DELIVERY CONDITION)

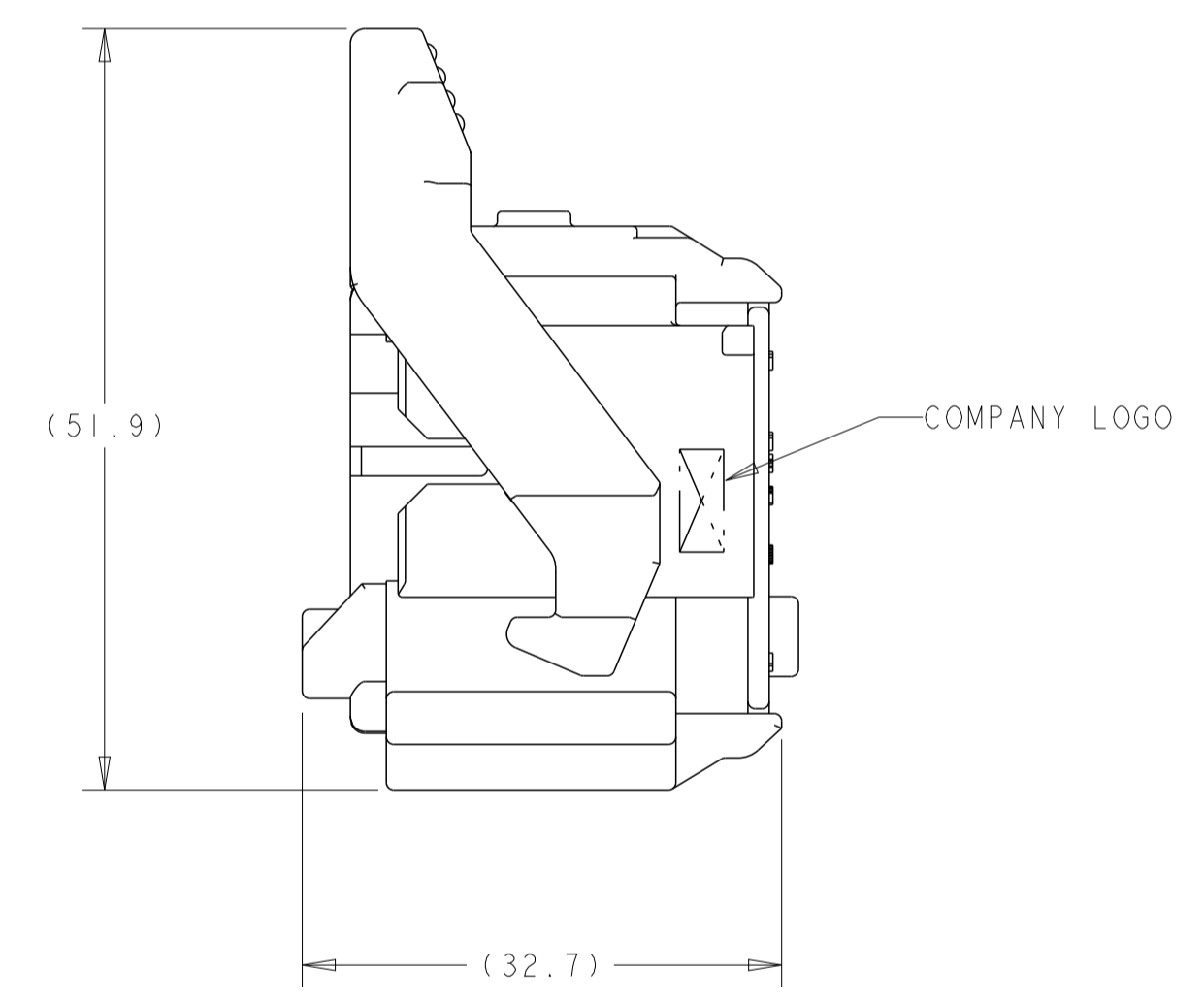
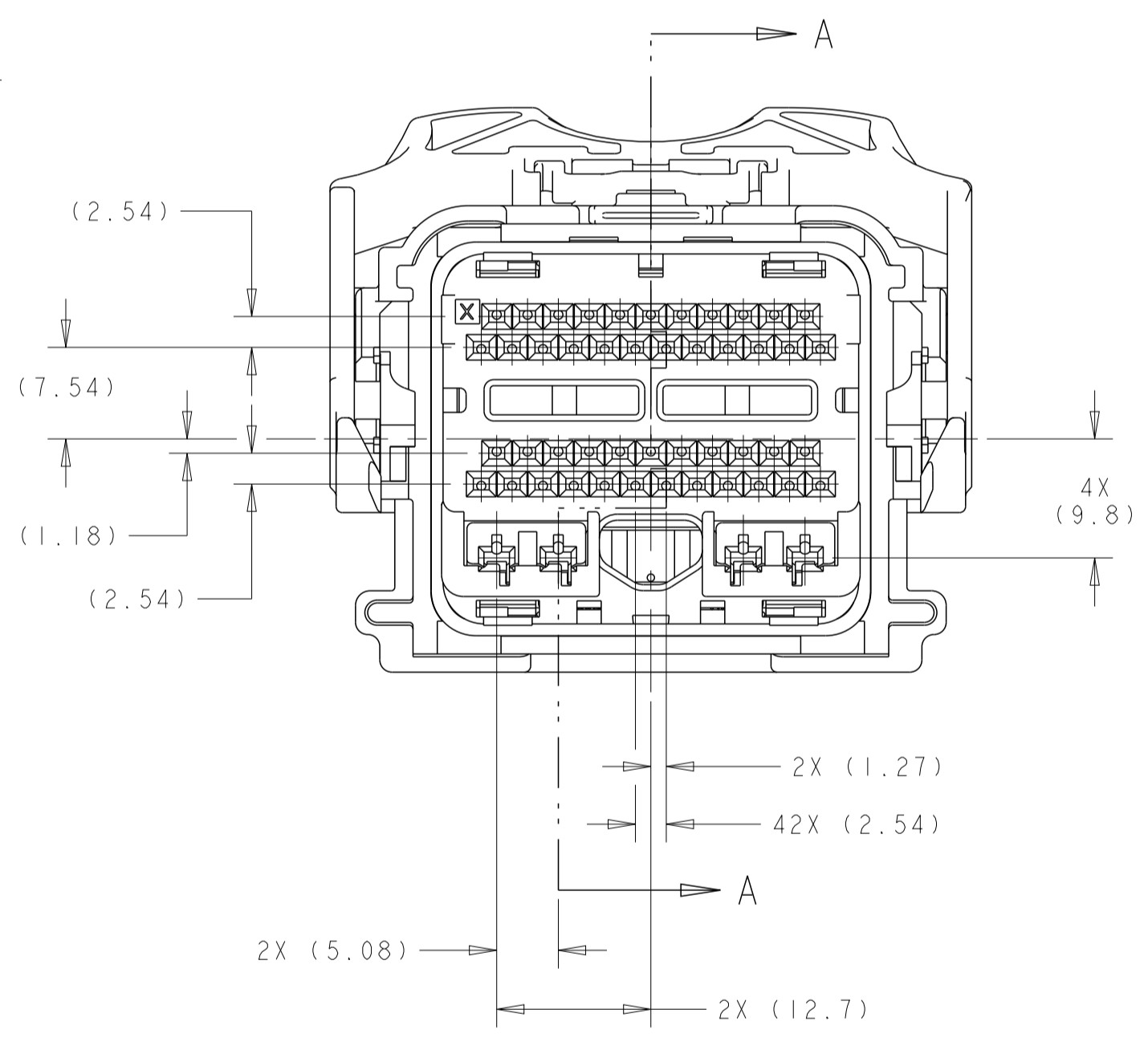

SHOWN WITH CAM
LEVER AND SPACER
IN LOADED POSITION

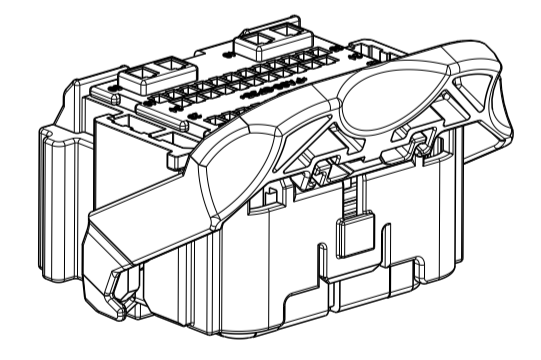
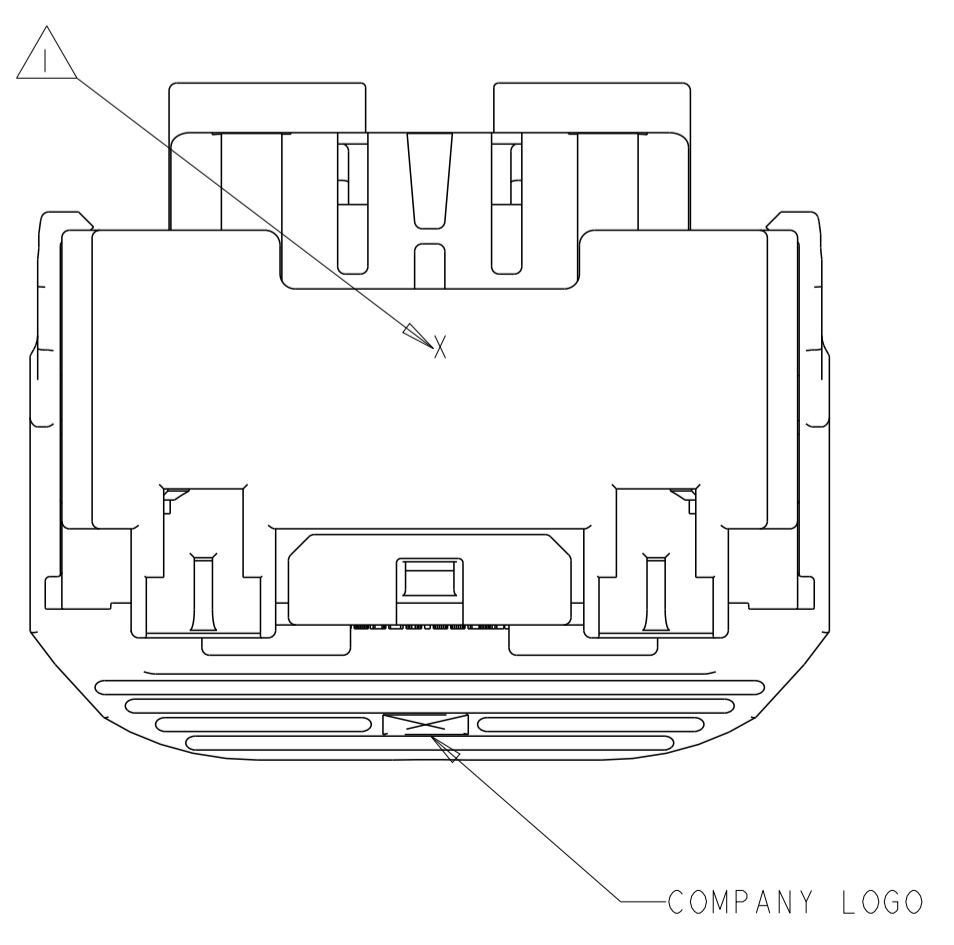

SCALE 1:1

PART COLOR	DESCRIPTION	ITEM NO.
GREEN	PERIMETER SEAL	6
GRAY	LEVER	5
BROWN	GROMMET SEAL	4
BLACK	COVER	3
NATURAL	SPACER	2
BLACK	HARNESS, KEY "C"	1

THIS DRAWING IS A CONTROLLED DOCUMENT.

DIMENSIONS:	TOLERANCES UNLESS OTHERWISE SPECIFIED:	DWN B. CRISAMORE 21 JUL 2004	CHK M. HITCHCOCK 21 JUL 2004	APVD C. MARTIN 21 JUL 2004
mm	0 PLC ±0.3	NAME PCM		
	1 PLC ±0.10	PRODUCT SPEC		
	2 PLC ±0.10	APPLICATION SPEC		
	3 PLC ±0.10	SIZE CAGE CODE DRAWING NO		
	4 PLC ±0.10	RESTRICTED TO		
	ANGLES ±1°	A100779C=1438693		
MATERIAL	FINISH	WEIGHT	CUSTOMER DRAWING	
-	-	-	SCALE 2:1	SHEET 1 OF 4

TE Connectivity

APPLICABLE HEADER INTERFACE SPECIFICATION SHOWN WITHOUT KEYING OPTIONS

REVISIONS				
P.	LTN.	DESCRIPTION	DATE	DWN. APVD.
-		SEE SHEET 1	-	-

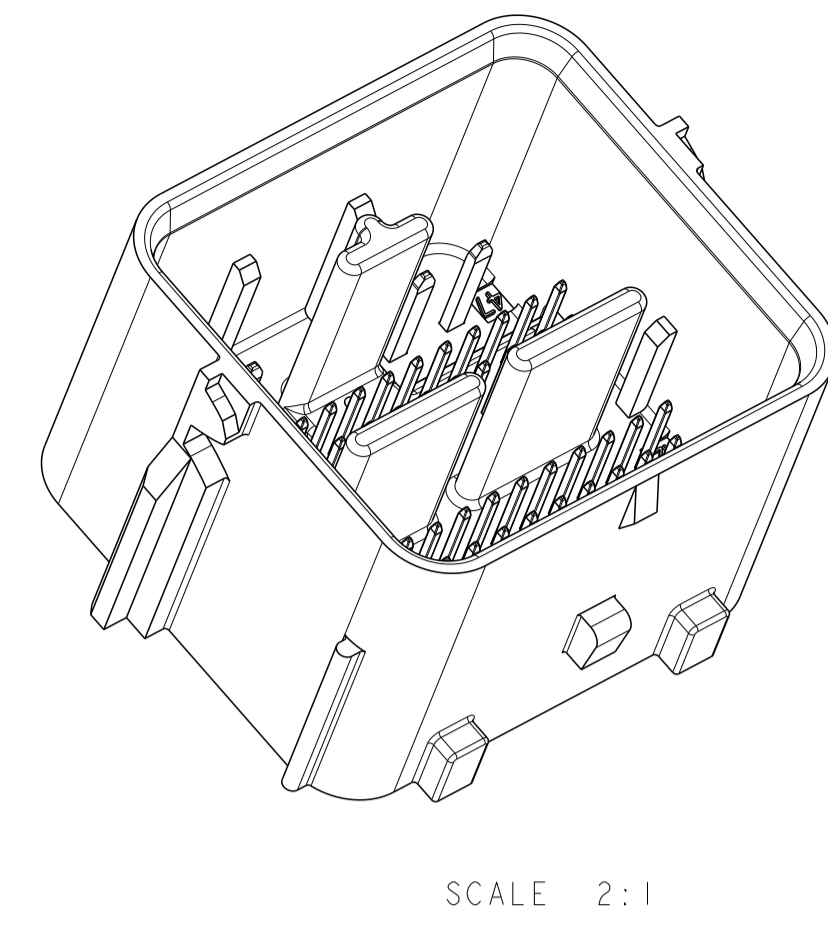
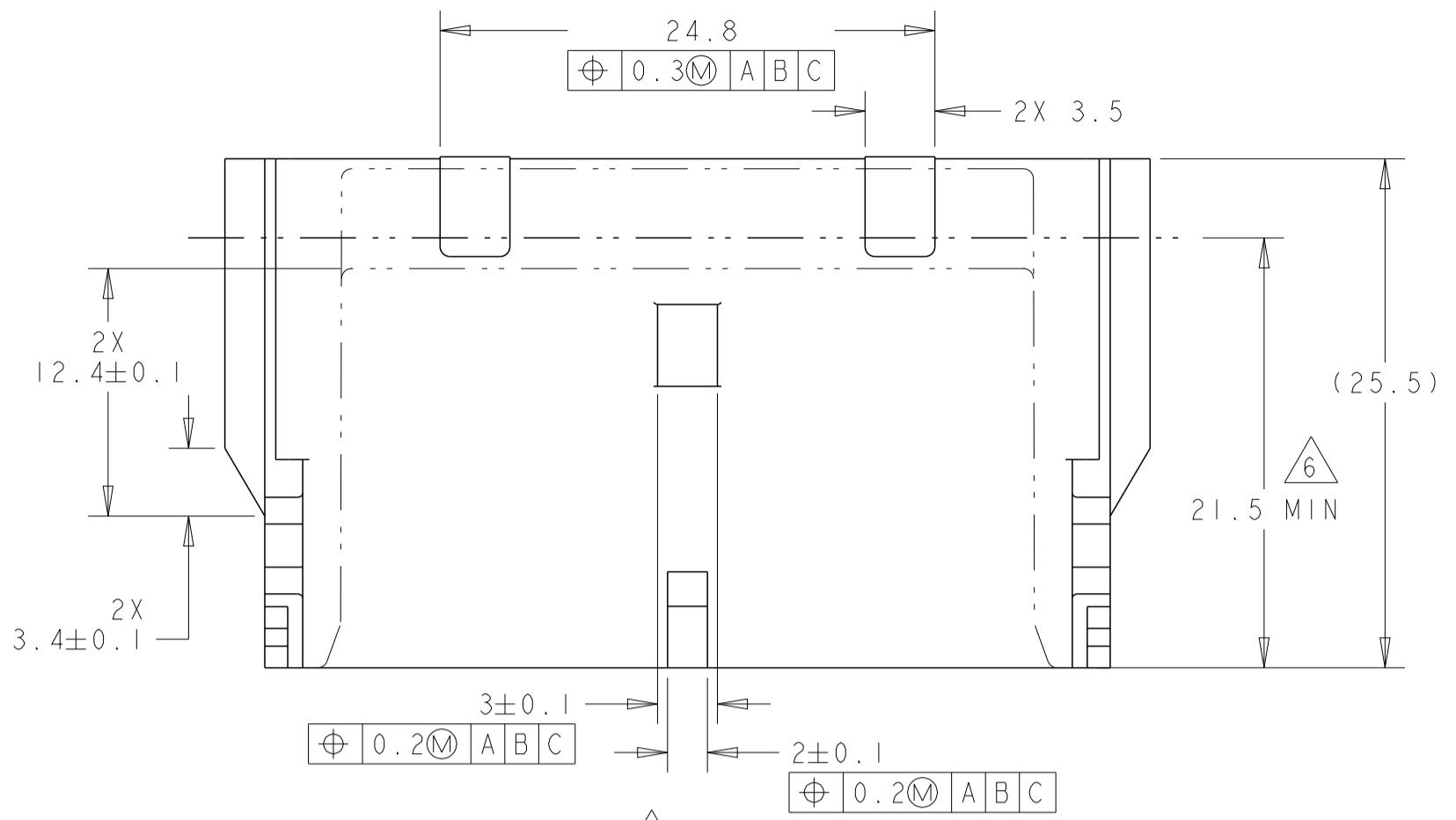
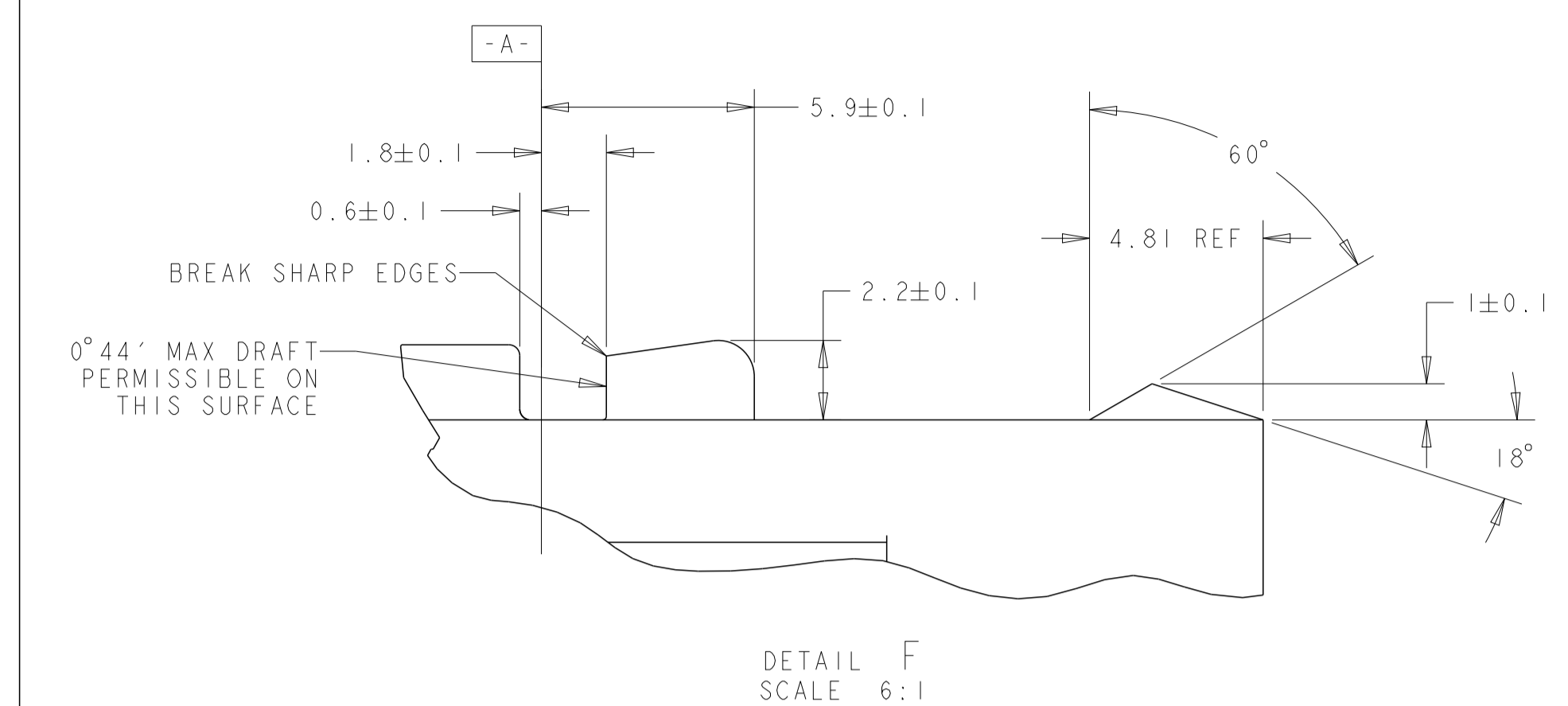

NOTES: UNLESS OTHERWISE SPECIFIED

1. GENERAL TOLERANCE:
 ±0.3 ALL ONE PLACE DIMENSIONS
 ±0.10 ALL TWO PLACE DIMENSIONS
 ±1°00' ALL ANGULAR DIMENSIONS
2. DRAFT ANGLE PERMISSIBLE ONLY WITHIN DRAWING TOLERANCE.
3. SEALING SURFACE, NO WITNESS LINES OR DAMAGE PERMITTED.
4. ALL UNMARKED RADII TO BE 0.5 MAX., UNLESS OTHERWISE SPECIFIED.
5. VENT HOLE SIZE AND LOCATION IS OPTIONAL.
6. THIS AREA TO REMAIN CLEAR FOR THE HARNESS ASSEMBLY.
7. TERMINAL POSITION IDENTIFICATION.

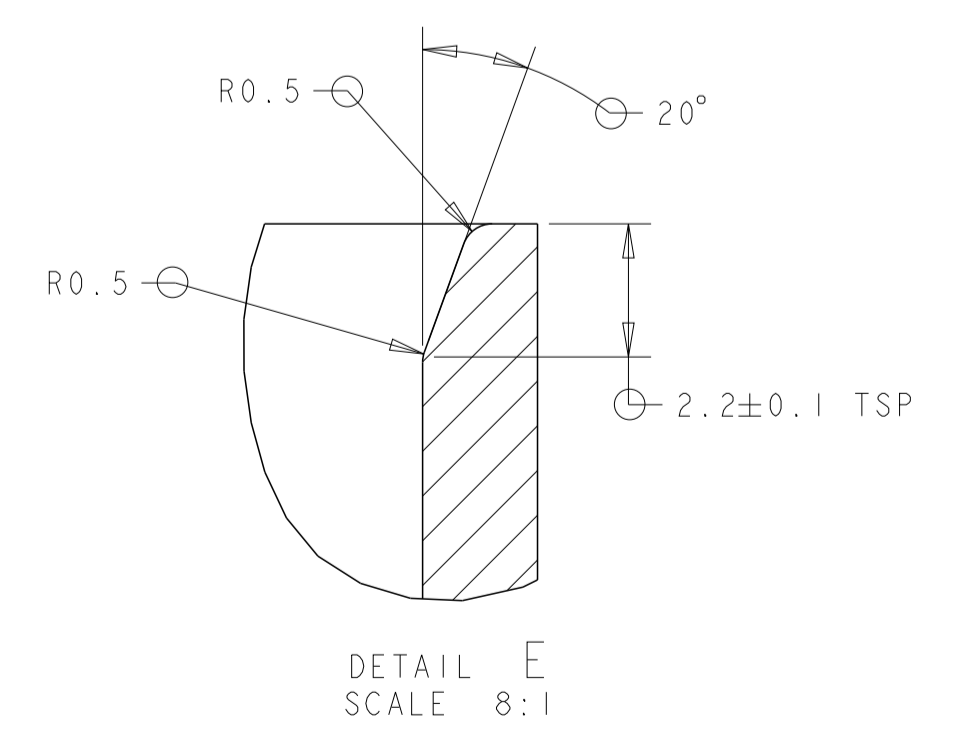
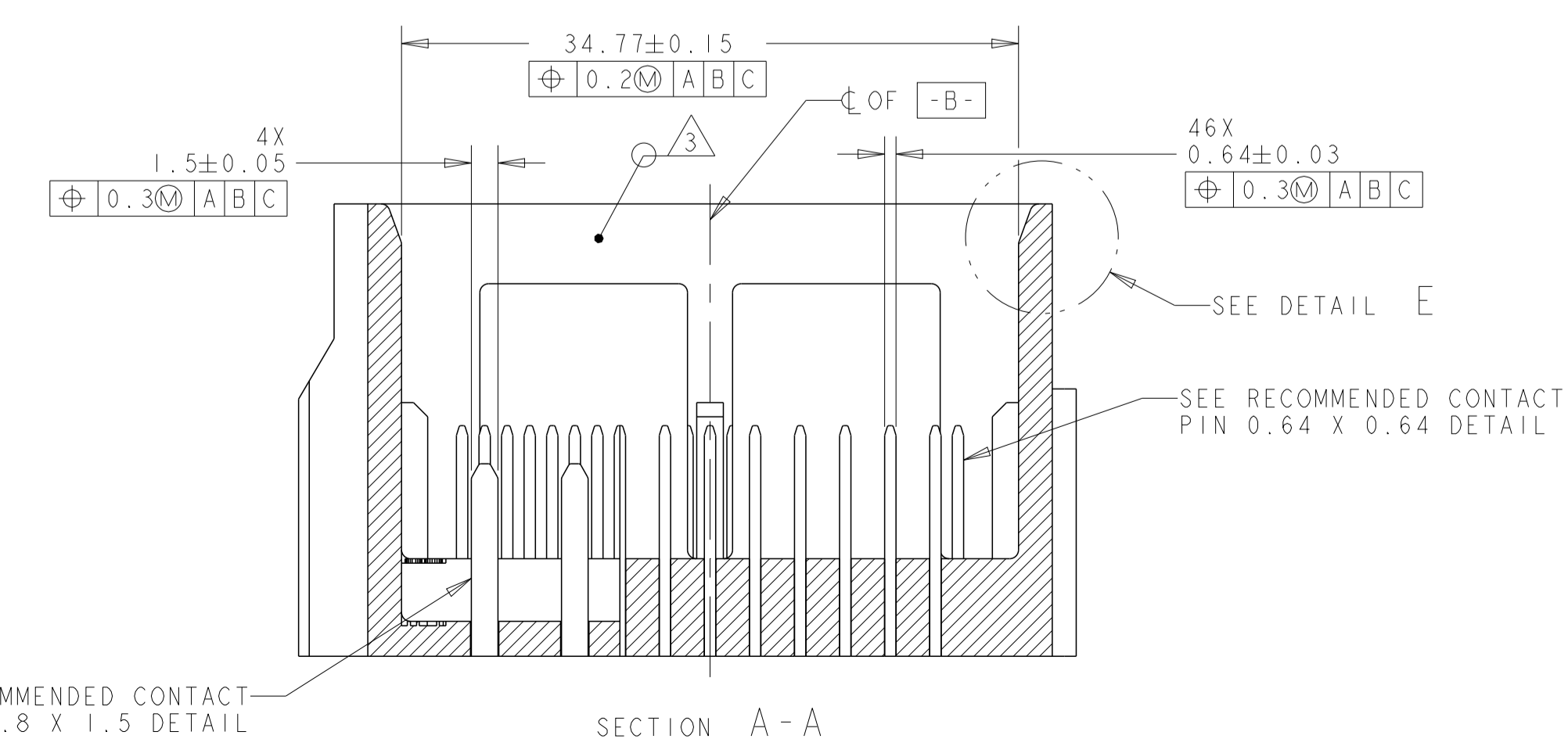
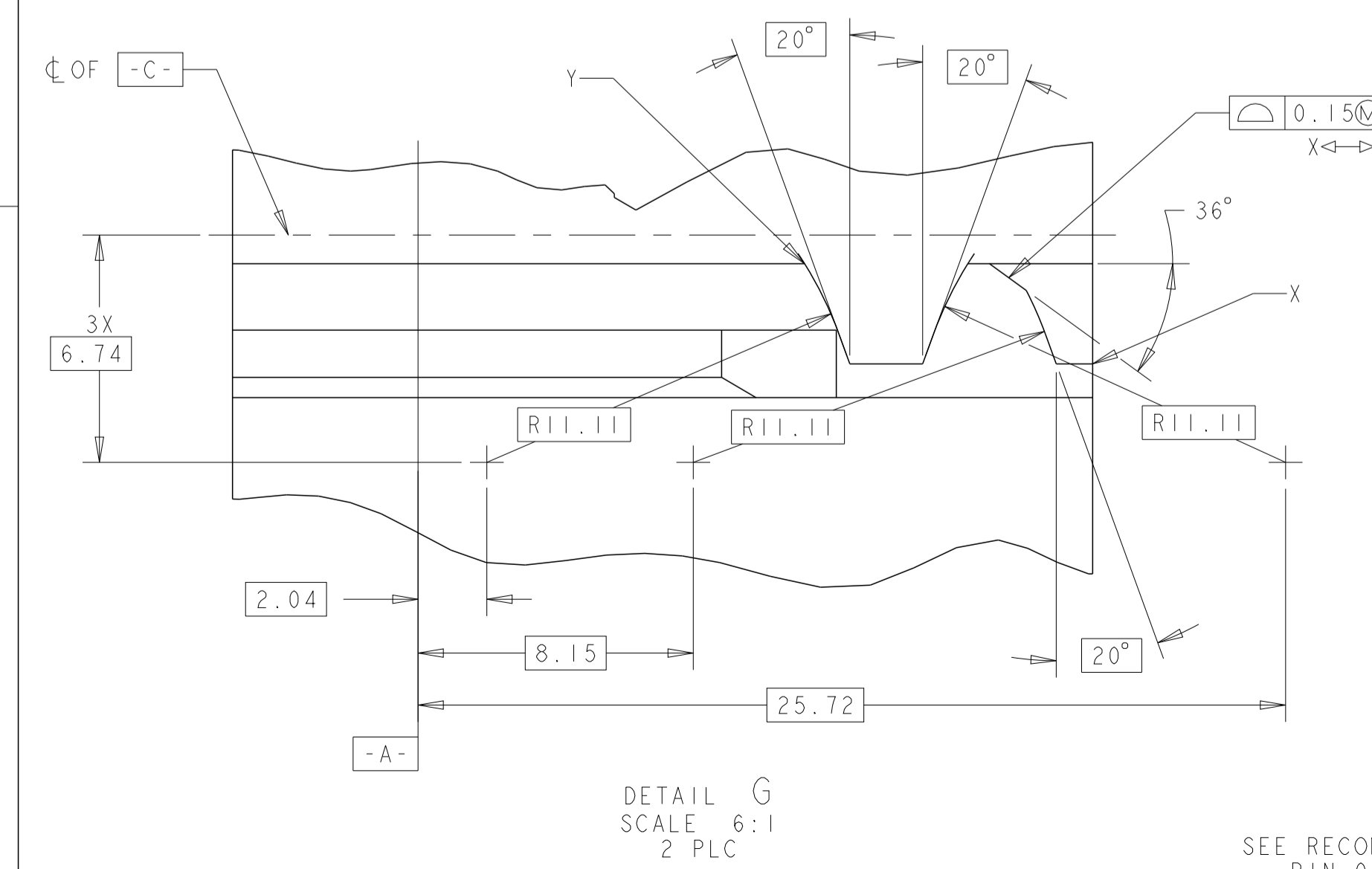
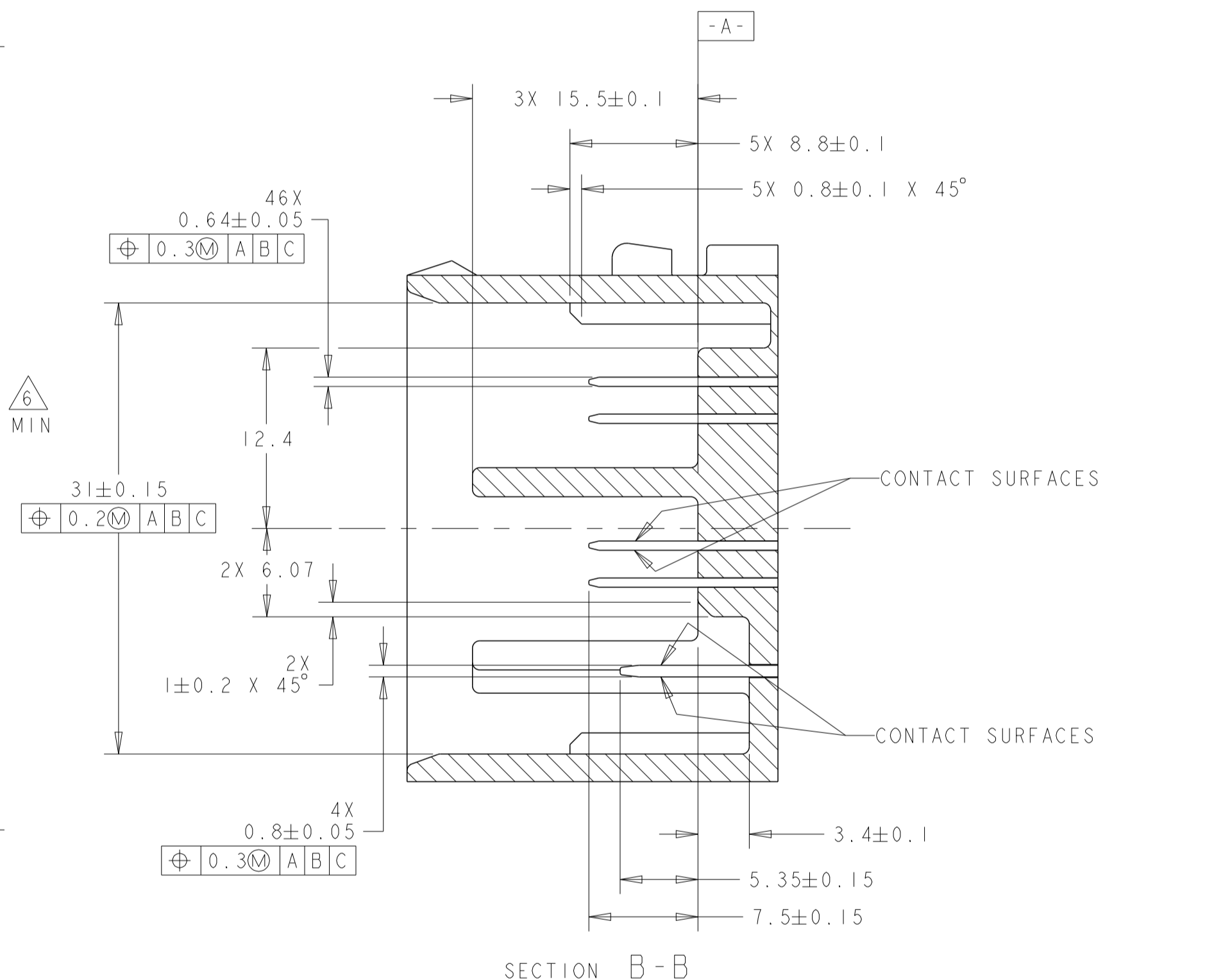
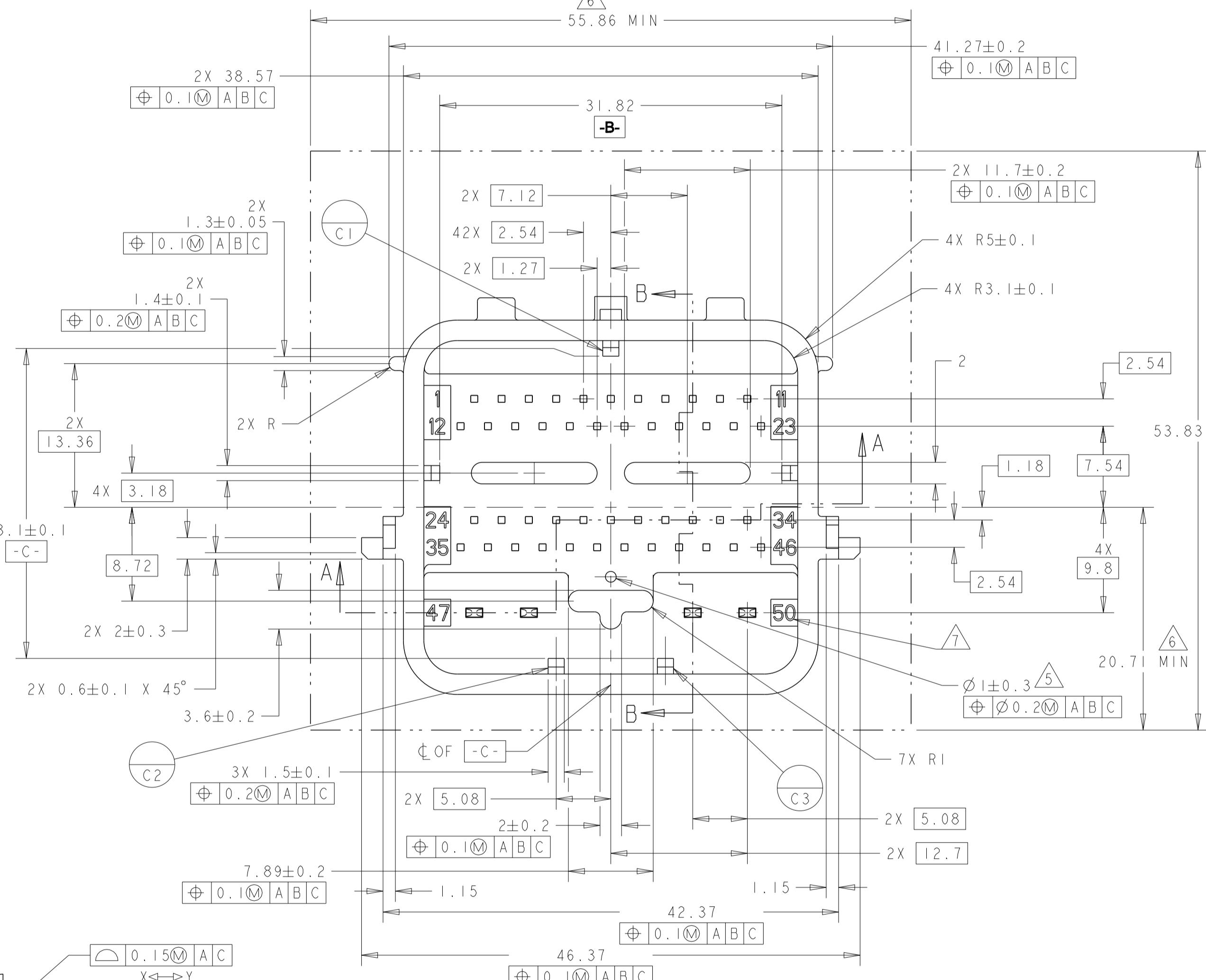
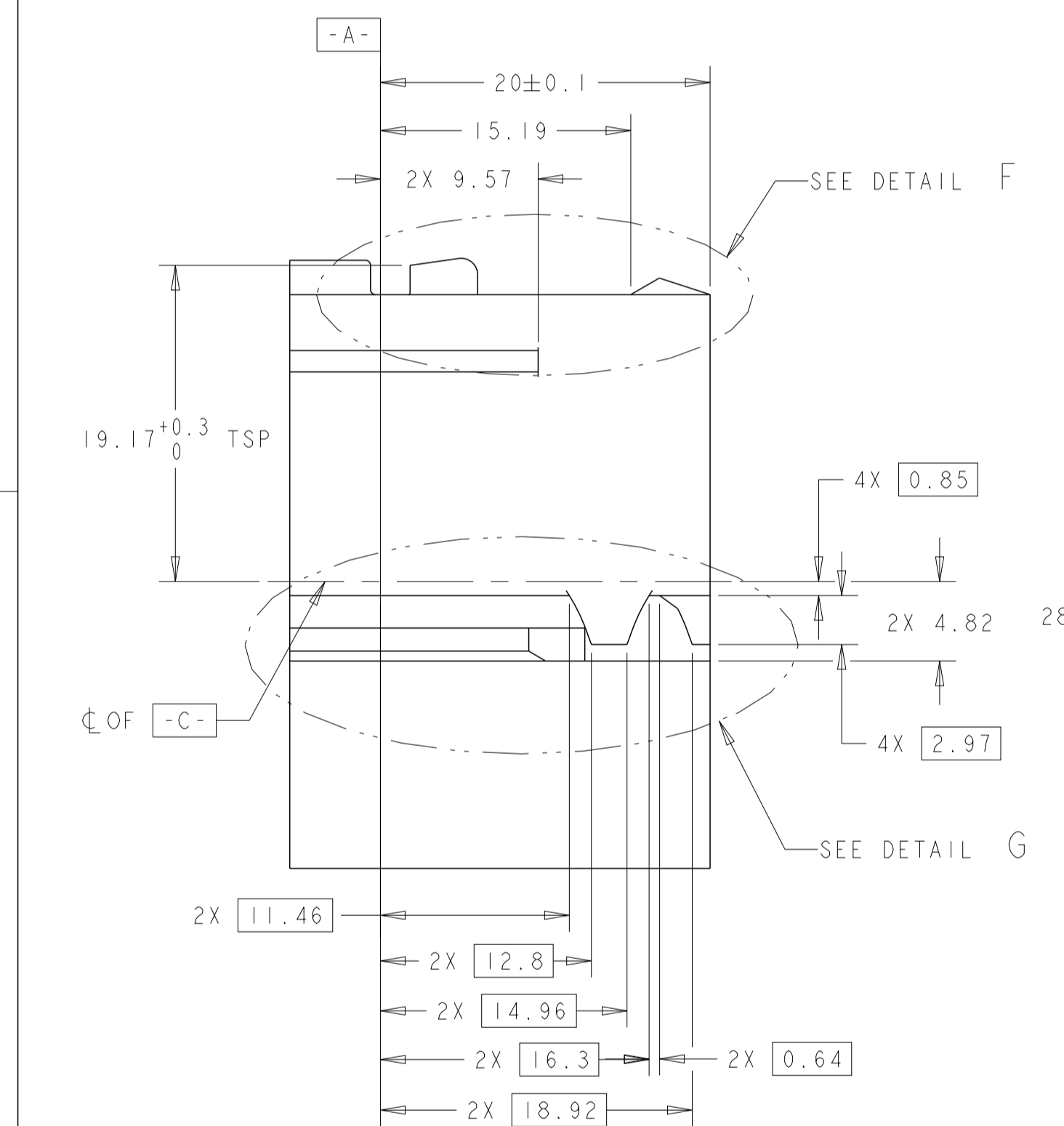

THIS DRAWING IS A CONTROLLED DOCUMENT.		DWN: B. CRISAMORE 21 JUL 2004	TE Connectivity
DIMENSIONS: mm		CHK: M. HITCHCOCK 21 JUL 2004	
DIMENSIONS: mm 0 PLC ±0.3 1 PLC ±0.3 2 PLC ±0.10 3 PLC ± 4 PLC ± ANGLES ±1°	TOLERANCES UNLESS OTHERWISE SPECIFIED:	NAME: PCM PRODUCT SPEC: 50-WAY HARNESS ASSEMBLY APPLICATION SPEC: KEY C SIZE: A1 CAGE CODE: 100779 DRAWING NO: 1438693	
	MATERIAL:		FINISH:

REVISIONS				
P	LN	DESCRIPTION	DATE	OWN
-	-	SEE SHEET 1	-	-

KEYING OPTION C

		48	47	46	45	44	43	42	41			39	38	37	36	35		33	32	31	30	29	28							14	13	12			9	8	7		5	4	3		1	3-1438693-2
		48			45	44	43	42	41			39	38	37	36	35		33	32	31	30	29	28							14	13	12			9	8	7		5	4	3		1	3-1438693-1
		48	47	46	45	44	43	42	41			39	38	37	36	35		33	32	31	30	29	28						14	13	12	10	9	8			5	4	3		1	3-1438693-0		
		48	47	46	45	44	43		41			39	38	37	36	35		33	32	31	30	29						14	13	12	10	9					5	4			1	2-1438693-9		
		48	47	46	45	44	43		41			39	38	37	36	35		33	32	31	30	29						14	13	12			9		7		5	4			1	2-1438693-8		
		48	47	46	45	44	43	42	41			39	38	37	36	35		33	32	31	30	29						14	13	12			9	8			5	4	3		1	2-1438693-7		
		48	47	46	45	44	43	42	41			39	38	37	36	35		33	32	31	30	29	28						14	13	12			9	8	7		5	4	3		1	2-1438693-6	
49		48			45	44	43	42	41			39	38	37	36	35		33	32	31	30	29	28						14	13	12	10	9	8			5	4	3		1	2-1438693-5		
		48			45	44	43	42	41			39	38	37	36	35		33	32	31	30	29	28						14	13	12			9	8	7		5	4	3		1	2-1438693-4	
		48	47	46	45	44	43	42	41			39	38	37	36	35		33	32	31	30	29	28						14	13	12	10	9	8	7		5	4	3		1	2-1438693-3		
49		48	47	46	45	44	43	42	41			39	38	37	36	35		33	32	31	30	29	28						14	13	12	10	9	8			5	4	3		1	2-1438693-2		
		48	47	46	45	44	43					39	38	37	36	35		33	32	31	30	29						14	13	12	10	9					5					1	2-1438693-1	
		48	47	46	45	44	43					39	38	37	36	35		33	32	31	30	29						14	13	12			9		7		5					1	2-1438693-0	
		48	47	46	45	44	43	42	41			39	38	37	36	35		33	32	31	30	29						14	13	12	10	9	8			5	4					1	1-1438693-9	
		48	47	46	45	44	43	42	41			39	38	37	36	35		33	32	31	30	29						14	13	12			9	8	7		5	4					1	1-1438693-8
		48	47	46	45	44	43					39	38	37	36	35		33	32	31	30	29						14	13	12	10	9					5					1	1-1438693-7	
		48	47	46	45	44	43					39	38	37	36	35		33	32	31	30	29						14	13	12			9		7		5					1	1-1438693-6	
		48	47	46	45	44	43	42	41			39	38	37	36	35		33	32	31	30	29						14	13	12	10	9	8			5	4					1	1-1438693-5	
		48	47	46	45	44	43	42	41			39	38	37	36	35		33	32	31	30	29						14	13	12			9	8	7		5	4					1	1-1438693-4
		48	47	46	45	44	43	42	41			39	38	37	36	35		33	32	31	30	29						14	13	12			9	8	7	6	5	4	3		1	1-1438693-3		
		48	47	46	45	44	43	42	41			39	38	37	36	35		33	32	31	30	29						14	13	12	10	9	8			6	5	4	3		1	1-1438693-2		
		48	47	46	45	44	43	42	41			39	38	37	36	35		33	32	31	30	29						14	13	12	10	9	8	7		5	4	3		1	1-1438693-1			
		48			45	44	43	42	41			39	38	37	36	35		33	32	31	30	29						14	13	12	10	9	8			6	5	4	3		1	1-1438693-0		
		48	47	46	45	44	43	42	41			39	38	37	36	35		33	32	31	30	29						14	13	12			9	8	7		5	4	3		1	1438693-9		
		48			45	44	43	42	41			39	38	37	36	35		33	32	31	30	29						14	13	12			9	8	7		5	4	3		1	1438693-8		
		48			45	44	43	42	41			39	38	37	36	35		33	32	31	30	29						14	13	12	10	9	8			5	4	3		1	1438693-7			
		48	47	46	45	44	43	42	41			39	38	37	36	35		33	32	31	30	29						14	13	12	10	9	8			5	4	3		1	1438693-6			
49		48			45	44	43	42	41			39	38	37	36	35		33	32	31	30	29						14	13	12	10	9	8			5	4	3		1	1438693-5			

CAVITIES WITH A NUMERIC SYMBOL INDICATES CLOSED TERMINAL LOCATIONS

BLANK CAVITIES INDICATES OPEN TERMINAL HOLE LOCATIONS

TERMINAL HOLE POSITION

50	49	48	47	46	45	44	43	42	41	40	39	38	37	36	35	34	33	32	31	30	29	28	27	26	25	24	23	22	21	20	19	18	17	16	15	14	13	12	11	10	9	8	7	6	5	4	3	2	1	ASSEMBLY PART NUMBER
----	----	----	----	----	----	----	----	----	----	----	----	----	----	----	----	----	----	----	----	----	----	----	----	----	----	----	----	----	----	----	----	----	----	----	----	----	----	----	----	----	---	---	---	---	---	---	---	---	---	----------------------

PIN-OUT CHART

THIS DRAWING IS A CONTROLLED DOCUMENT.

DWNS: B. CRISAMORE 21 JUL 2004
 CHK: M. HITCHCOCK 21 JUL 2004
 APVD: C. MARTIN 21 JUL 2004

TE Connectivity

NAME: PCM 50-WAY HARNESS ASSEMBLY KEY C
 SIZE: A100779 C=1438693
 SCALE: 2:1 SHEET 3 OF 4 REV: A12

RESTRICTED TO

REVISIONS				
P	LTN	DESCRIPTION	DATE	APVD
-		SEE SHEET 1	-	-

KEYING OPTION C			48	47	46	45	44	43					39	38	37	36	35			33	32	31	30	29			26					22	21	20	19	18					14	13	12			10	9			6	5			1	4-1438693-6	
			48	47	46	45	44	43					39	38	37	36	35			33	32	31	30	29			26					22	21	20	19	18					14	13	12			9	7	6	5			1	4-1438693-5			
			48	47	46	45	44	43	42	41			39	38	37	36	35			33	32	31	30	29			26					22	21	20	19	18					14	13	12	10	9	8	6	5	4			1	4-1438693-4			
			48	47	46	45	44	43	42	41			39	38	37	36	35			33	32	31	30	29			26					22	21	20	19	18					14	13	12		9	8	7	6	5	4			1	4-1438693-3		
			48	47	46	45	44	43	42	41			39	38	37	36	35			33	32	31	30	29	28			26					22	21	20	19	18					14	13	12		9	8	7	6	5	4	3			1	4-1438693-2
			48	47	46	45	44	43	42	41			39	38	37	36	35			33	32	31	30	29			26					22	21	20	19	18					14	13	12		9	8	7	6	5	4	3			1	4-1438693-1	
		49	48	47	46	45	44	43	42	41			39	38	37	36	35			33	32	31	30	29			26					22	21	20	19	18					14	13	12	10	9	8	6	5	4	3			1	4-1438693-0		
		49	48	47	46	45	44	43	42	41			39	38	37	36	35			33	32	31	30	29	28			26					22	21	20	19	18					14	13	12	10	9	8	6	5	4	3			1	3-1438693-9	
			48	47	46	45	44	43	42			39	38	37	36	35			33	32			29	28			26					22	21	20	19	18					14	13	12	10	9	8	7	5	4	3			1	3-1438693-8		
			48	47	46	45	44	43	42			39	38	37	36	35			33	32			29	28			26	25	24	23	22	21	20	19	18					14	13	12		9	8	7	5	4	3			1	3-1438693-7			

CAVITIES WITH A NUMERIC SYMBOL INDICATES CLOSED TERMINAL LOCATIONS

BLANK CAVITIES INDICATES OPEN TERMINAL HOLE LOCATIONS

TERMINAL HOLE POSITION

PIN-OUT CHART

ASSEMBLY PART NUMBER

THIS DRAWING IS A CONTROLLED DOCUMENT.		DWN B. CRISAMORE 21 JUL 2004 CHK M. HITCHCOCK 21 JUL 2004 APVD C. MARTIN 21 JUL 2004	
DIMENSIONS: mm 	TOLERANCES UNLESS OTHERWISE SPECIFIED: 0 PLC ±0.3 1 PLC ±0.10 2 PLC ±0.10 3 PLC ±0.10 4 PLC ±0.10 ANGLES ±1° FINISH	NAME PCM PRODUCT SPEC 50-WAY HARNESS ASSEMBLY APPLICATION SPEC KEY C	SIZE A1 CAGE CODE 00779 DRAWING NO. 1438693
MATERIAL	WEIGHT	CUSTOMER DRAWING	RESTRICTED TO SCALE 2:1 SHEET 4 OF 4 REV A12