

TL6300 SERIES TACT SWITCH

ANTI-VANDAL SWITCHES
 DETECTOR SWITCHES
 DIP SWITCHES
 KEYLOCK SWITCHES
 NAVIGATION SWITCHES
 PUSHBUTTON SWITCHES
 ROCKER SWITCHES
 ROTARY SWITCHES
 SLIDE SWITCHES
 SNAP ACTION SWITCHES
TACTILE SWITCHES
 TOGGLE SWITCHES
 CAP OPTIONS

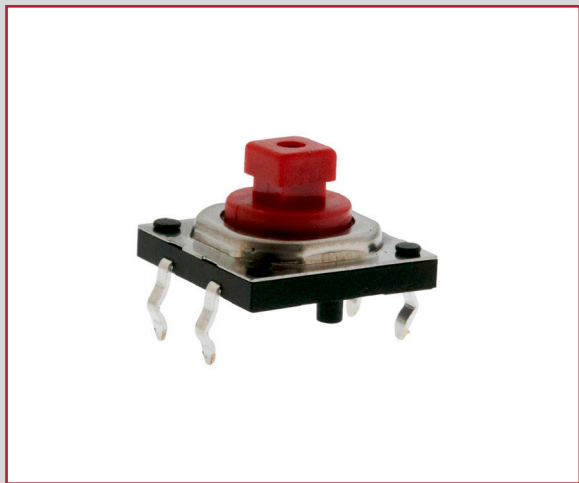

APPLICATIONS / MARKETS

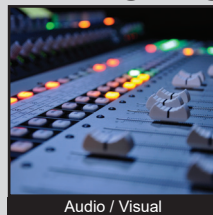

Audio / Visual

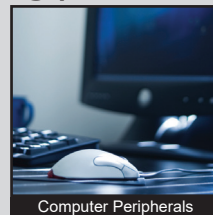

Computer Peripherals

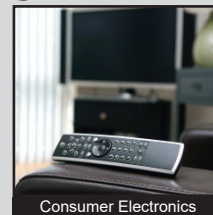

Consumer Electronics



Instrumentation

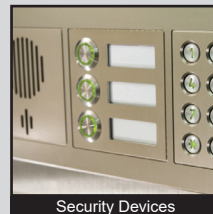

Security Devices



Medical Equipment

RoHS

SPECIFICATIONS

Contact Arrangement: SPST
Contact Rating: 50mA @ 12VDC
Contact Resistance: 100mΩ Initial
Insulation Resistance: 100 MΩ @ 100 VDC
Dielectric Strength: 250 VAC
Electrical Life: 10,000,000 cycles
Operating Temperature: -40°C to 90°C
Storage Temperature: -40°C to 90°C
Travel: 0.3mm
Actuation Force: 260 gf
Moisture Protection: IP67
Bounce: 10m Second Max.

FEATURES & BENEFITS

- 10,000,000 cycle life expectancy
- IP67 ingress protection
- PCB Mount
- Sharp tactile response

PART NUMBER CONFIGURATOR

Series	Actuator	Actuation Force	Contact Material	Terminal
<input type="text" value="TL6300"/>	<input type="text" value="A - 7.30mm Height"/>	<input type="text" value="F260 - 260 gf"/>	<input type="text" value="Q - Silver"/>	<input type="text" value="P - Thru Hole PCB"/>

Specifications subject to change without notice 2.15.2019



E-SWITCH®

www.e-switch.com

800.867.2717

1

TL6300 SERIES TACT SWITCH

BODY DIMENSIONS

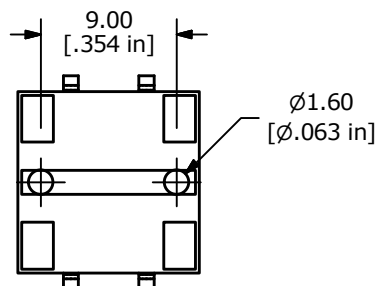
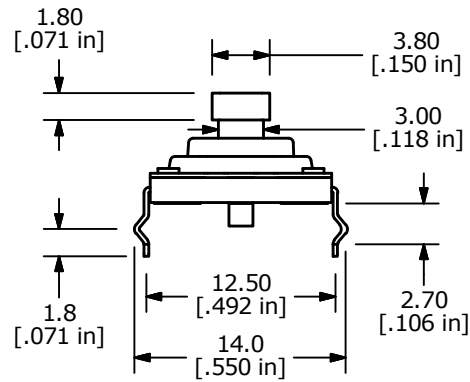
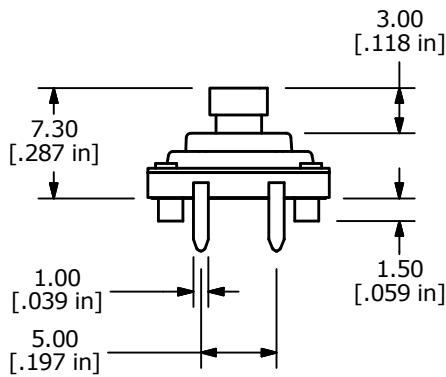
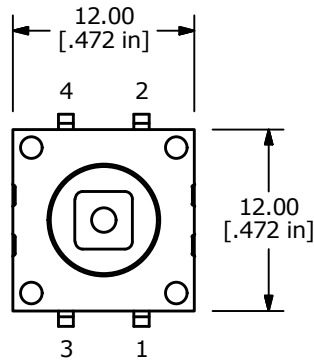
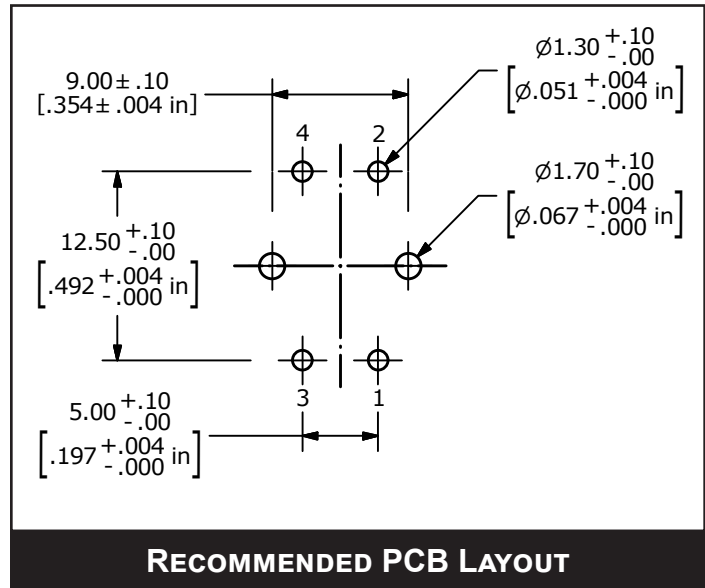
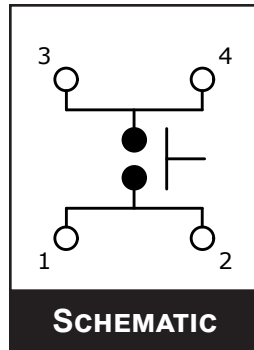

- ANTI-VANDAL SWITCHES
- DETECTOR SWITCHES
- DIP SWITCHES
- KEYLOCK SWITCHES
- NAVIGATION SWITCHES
- PUSHBUTTON SWITCHES
- ROCKER SWITCHES
- ROTARY SWITCHES
- SLIDE SWITCHES
- SNAP ACTION SWITCHES
- TACTILE SWITCHES**
- TOGGLE SWITCHES
- CAP OPTIONS

