



**MODEL:** SP-1609S-2  
**PRODUCT:** Dynamic Speaker  
**EDITION:** A/2016

**THIS SPECIFICATION COVERS OUR PRODUCT OF DYNAMIC SPEAKER UNIT FOR MOBILE TELEPHONE USE**

**SPEAKER ELECTROACOUSTIC CHARACTERISTICS**

|                          |  |
|--------------------------|--|
| sound pressure level     | 82±3dB SPL @0.6,0.8 ,1.0,1.5and2.0KHz in average (0dB SPL=20µPa)   |
| measuring condition      | 0.5W (Sine wave) 10cm in 1cc closed box measured with baffler shown in Fig.1.  |
| frequency response curve | As shown in fig(3)   |
| response frequency       | 670±20%Hz @ 1V in free air<br>900±20%Hz @ 1V in 1cc closed box   |
| rated noise power        | 0.5W (in 1cc closed box)   |
| short term max. power    | 0.8W (in 1cc closed box)   |
| operation test           | Must be free of audible noise (buzzes and rattles)<br>(300 ~ 5KHz frequency range ,input level up to 2.0Vrms in 1cc box) |
| distortion               | Less than 10% @1KHz,0.1M,0.1W frequency range ,input level up to 0.1W  |

**GENERAL SPECIFICATIONS**

|                             |                                   |
|-----------------------------|-----------------------------------|
| operating temperature range | -20°C ~+60°C                      |
| standard test conditions    |                                   |
| temperature                 | 17°C ~25°C                        |
| relative humidity           | 45%~80%(RH)                       |
| ac impedance                | 8Ω ±15%(@2KHz 1V) without baffler |
| dimension                   | 16 x 9 x 4.5 mm                   |

**RELIABILITY TESTS**

The sound pressure as specified shall neither deviate more than ±3dB form the initial value, nor have any significant damage after any of following testing.

**HIGH TEMPERATURE TEST**

|                  |          |
|------------------|----------|
| high temperature | +60±2°C  |
| duration         | 96 hours |

**LOW TEMPERATURE TEST**

|                 |          |
|-----------------|----------|
| low temperature | -20±2°C  |
| duration        | 96 hours |

**HEAT SHOCK TEST**

|                  |             |
|------------------|-------------|
| high temperature | +60±2°C     |
| low temperature  | -20±2°C     |
| changeover time  | <30 seconds |
| duration         | 1 hour      |
| cycle            | 100         |



**MODEL:** SP-1609S-2  
**PRODUCT:** Dynamic Speaker  
**EDITION:** A/2016

**RELIABILITY TESTS** (Continued)

**HUMIDITY TEST**

|                   |          |
|-------------------|----------|
| temperature       | + 40±2°C |
| relative humidity | 90%~95%  |
| duration          | 96 hours |

**TEMPERATURE CYCLE TEST**

|                      |                     |
|----------------------|---------------------|
| temperature          | -20°C +60°C         |
| duration             | 45minutes 45minutes |
| temperature gradient | 1~3°C/min           |
| cycle                | 25                  |

**DROP TEST**

|                             |   |
|-----------------------------|---|
| mounted with dummy set mass | 100 g                                   |
| height                      | 1.5 m                                   |
| cycle                       | 6(1 each plain) Onto the concrete board |

**LOAD TEST**

|              |  |
|--------------|--|
| Speaker mode | white noise(EIA filter)for 1 hour@0.5W(in 1CC box) input power |
|--------------|--|

**MEASURING METHOD (SPEAKER MODE)**

**TEST CONDITION**

**STANDARD**

|                      |                     |
|----------------------|---------------------|
| temperature          | 15 ~ 35°C           |
| relative humidity    | 45% ~ 85%           |
| atmospheric pressure | 860mbar to 1060mbar |

**STANDARD TEST FIXTURE**

|                     |             |
|---------------------|-------------|
| input power         | 0.1W(0.89V) |
| zero level          | -dB         |
| mode                | TSR         |
| potentiometer range | 50dB        |
| sweep time          | 0.5sec      |

(Fig. 1)

Standard test condition of speaker

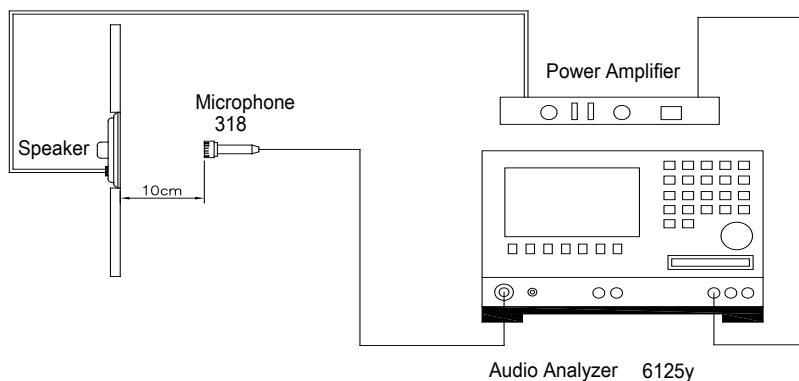



**MODEL:** SP-1609S-2  
**PRODUCT:** Dynamic Speaker  
**EDITION:** A/2016

**FREQUENCY RESPONSE CURVE** (Fig. 2)

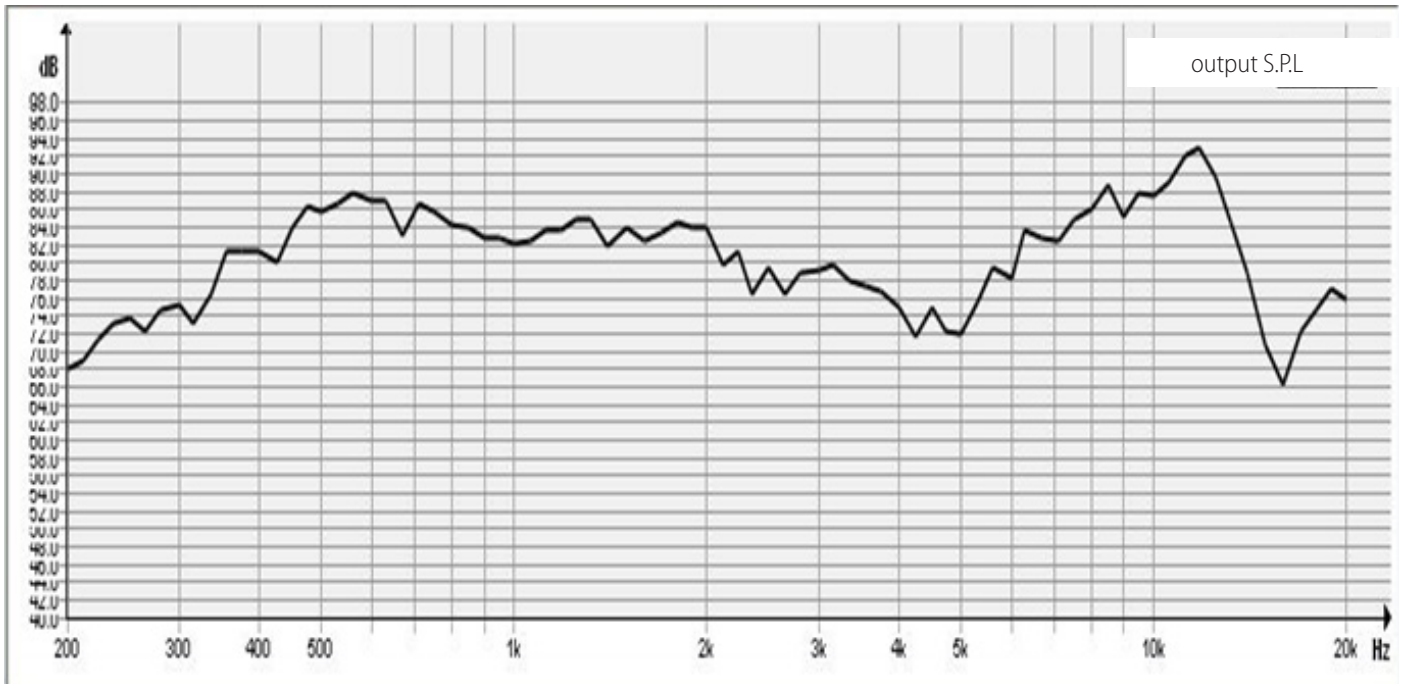

32  $\Omega$  dynamic speaker test

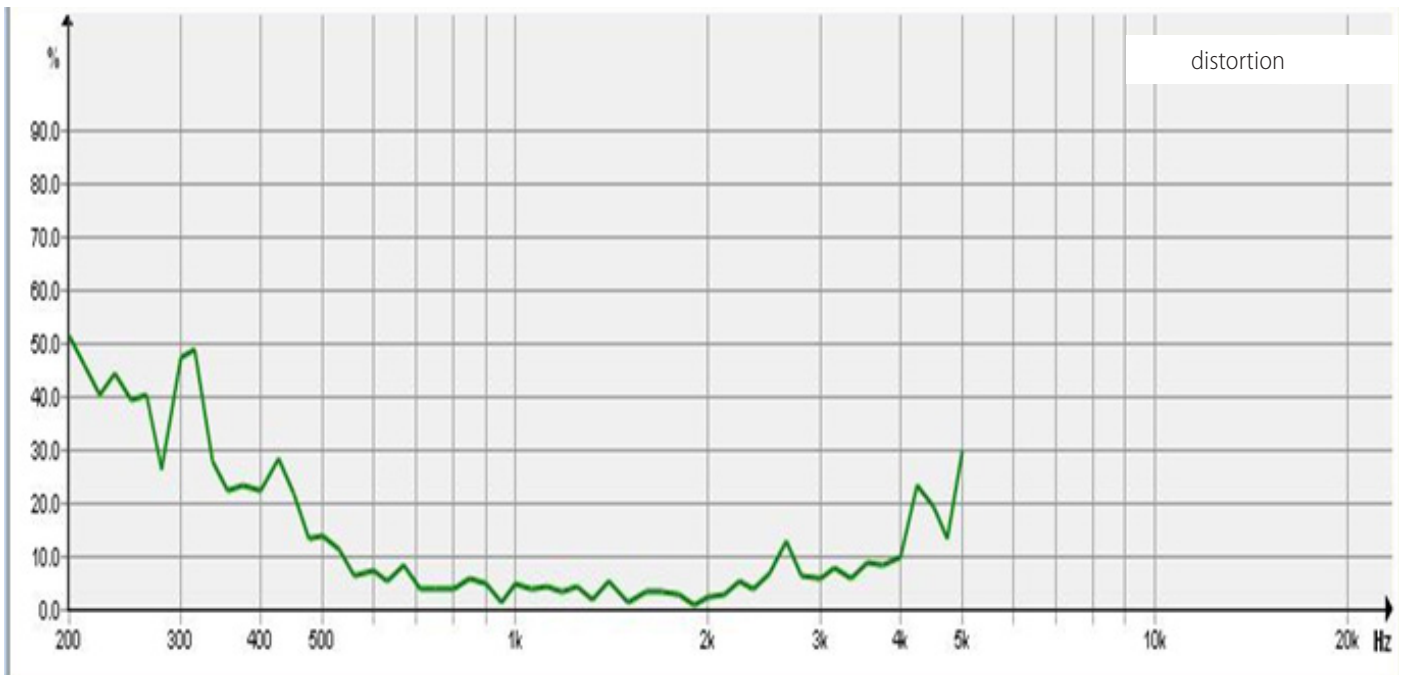



**MODEL:** SP-1609S-2  
**PRODUCT:** Dynamic Speaker  
**EDITION:** A/2016

**DIMENSIONS**

Tolerance:  $\pm 0.5$  (unit: mm)

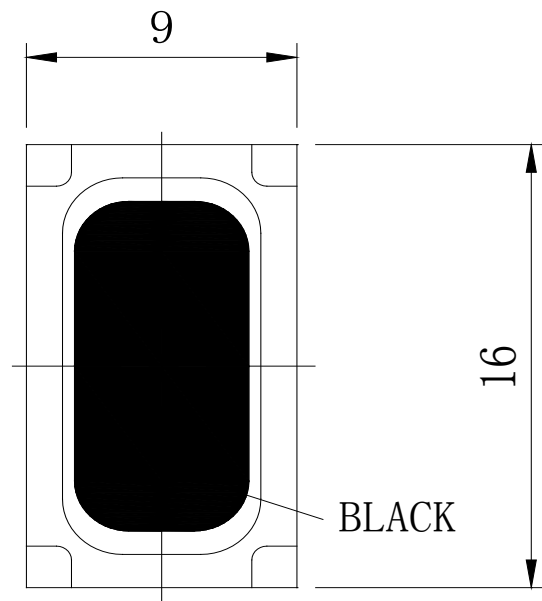
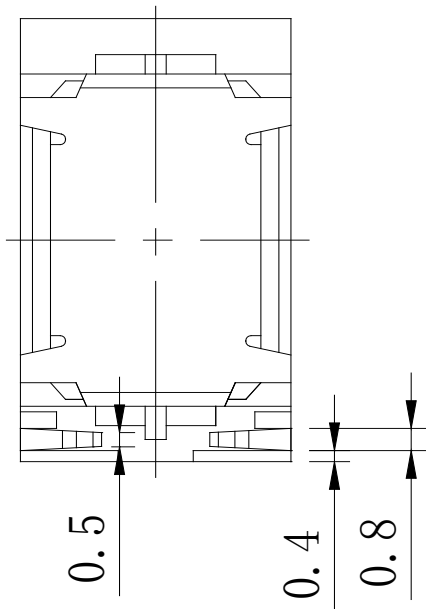
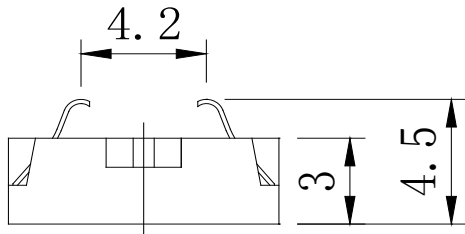

| no. | part name  | material              | quantity |
|-----|------------|-----------------------|----------|
| 1   | Cap        | Scotch ABS            | 1        |
| 2   | Diaphragm  | PEEK                  | 1        |
| 3   | Magnet     | Nd Fe B 9.15*5*1      | 1        |
| 4   | Plate3     | SPCC 9.2*5.1*0.4      | 1        |
| 5   | Voice Coil | POLYURETHANEENAMELLED | 1        |
| 6   | Frame      | BLACK PBT             | 1        |



**MODEL:** SP-1609S-2  
**PRODUCT:** Dynamic Speaker  
**EDITION:** A/2016

**PACKING**

