

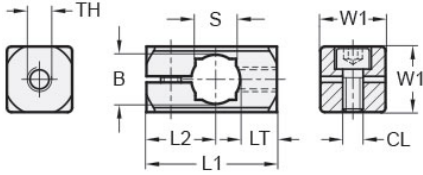

MT12-CSBC-M6-A

Ruland Sensor Bracket Clamp Connector, Thru Hole 12mm, Thread M6, L 32mm, Aluminum



Description

Ruland MT12-CSBC-M6-A is a sensor bracket clamp connector that attaches to a 12mm round or 10mm square tube and has an M6 center tapped hole, 16mm width and height, and 32mm overall length. It is designed to fit on Ruland tubes and flange bolt bases that begin with MT12. MT12-CSBC-M6-A is aluminum and screws are 304 stainless steel for use in most industrial applications. This bracket clamp is used to support brackets for mounting sensors, screens, reflectors, plexiglass machine guards, and other industrial components. The bracket is mounted directly to the clamp by a single M6 screw. An MT10:12-ALK-M5-20 adjustable clamping handle can be used to rapidly reposition MT12-CSBC-M6-A or the tube it is attached to without the use of tools. MT12-CSBC-M6-A is manufactured by Otto Ganter, inventoried by Ruland, and RoHS3 compliant.

Product Specifications

Thru Hole Diameter B	12 mm	Thru Hole Tolerance	+0.11/-0 mm
Square Thru Hole S	10 mm	Thread (TH)	M6
Thread Depth LT	9 mm	Edge To Center L2	17 mm
Width & Height W1	16 mm	Overall Length L1	32 mm
Clamp Screw CL	M5	Weight (lbs)	0.037800
Material Specification	Aluminum	Manufacturer	JW Winco/ Otto Ganter
UPC	634529230633	Country of Origin	Germany
Tariff Code	7609.00.0000	UNSPC	31162908
Note 1	Performance ratings are for guidance only. The user must determine suitability for a particular application.		
Prop 65	⚠ WARNING This product can expose you to the chemical Nickel (metallic), known to the State of California to cause cancer. For more information go to www.P65Warnings.ca.gov .		