

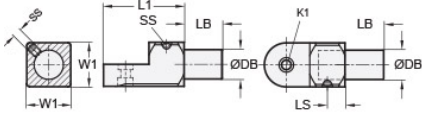

MT12-CSSWS-A

Ruland Set Screw Swivel Clamp Joint With Stud, Swivel Thru Hole 5.5mm,
Stud Diameter 12mm, Stud Length 19mm, L 57mm, Aluminum

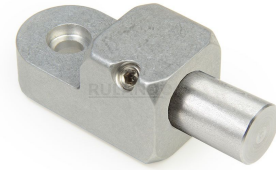

Description

Ruland MT12-CSSWS-A is a swivel clamp joint with stud with 12mm stud diameter, 19mm stud length, M5 set screw, 10mm base height, 20mm width and height, and 38mm overall length. It is designed to fit with MT10:12 swivel clamp bases, MT12 clamp connectors and mounting blocks, and MT12 round tubes. When combined with a swivel bases or attachment clamp joints, it is an ideal articulating mounting solution for screens, sensors, reflectors, plexiglass machine guards, and other components that require frequent adjustments. The stud allows for a more compact installation than other connectors which require the use of a second tube that is significantly longer than the stud. An MT10:12-ALK-M5-20 adjustable clamping handle can be used to join it to other Ruland swivel components for rapid repositioning without the use of tools. This part is aluminum with a matte tumbled finish for use in most industrial environments. MT12-CSSWS-A is manufactured by Otto Ganter, inventoried by Ruland, and RoHS3 compliant.

Product Specifications

Bolt Diameter DB	12 mm	Bolt Length LB	19 mm
Counterbore 1 Diameter K1	8.5 mm	Counterbore 2 Diameter K2	5.5 mm
Overall Length L1	38 mm	Hub Length LH	17 mm
Edge To Center L2	28 mm	Base Height H1	10 mm
Width & Height W1	20 mm	Hole Depth T	12 mm
Set Screw SS	M5	Screw To Edge LS	8 mm
Material Specification	Aluminum	Manufacturer	JW Winco/ Otto Ganter
Country of Origin	Germany	Weight (lbs)	0.112900
UPC	634529230152	Tariff Code	7609.00.0000
UNSPC	31162908		

Note 1 Performance ratings are for guidance only. The user must determine suitability for a particular application.

Prop 65  **WARNING** This product can expose you to the chemical Nickel (metallic), known to the State of California to cause cancer. For more information go to www.P65Warnings.ca.gov.