

SPECIFICATION CONTROL DRAWING

THIS DRAWING CONTAINS INFORMATION PROPRIETARY TO RF INDUSTRIES, LTD. ANY UNAUTHORIZED USE OF THIS DRAWING IS EXPRESSLY PROHIBITED. ANY VIOLATION IS PUNISHABLE UNDER U.S. COPYRIGHT LAWS.

REV	DESCRIPTION	DWN	DATE	APPROVED
A	ENGINEERING RELEASE	CZS	11/10/97	R. RICE
B	WAS RFX-8000-1B	CZS	6/3/99	R. RICE

ALL DIMENSIONS ARE REFERENCE ONLY

008974

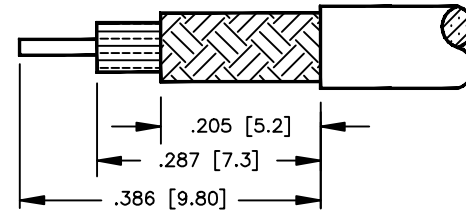
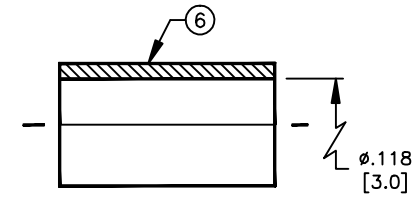
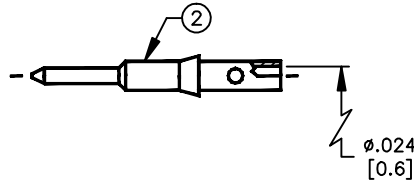
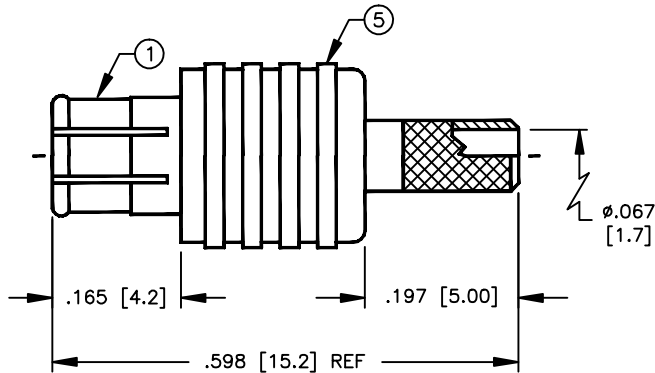

SUGGESTED STRIPPING INSTRUCTIONS

SUGGESTED CRIMP DIES: .130
PIN TO BE SOLDER

SPECIFICATIONS:

IMPEDANCE: 50 OHMS
 WORKING VOLTAGE: 335 VRMS @ SEA LEVEL
 FREQUENCY RANGE: 0-6 GHz
 INSERTION LOSS: ≤ .1 dB MAX/1 GHz
 VSWR: 1.3 MAX @ 6 GHz
 FOR RG-174, 188, 188A, 316/U, ALPHA 9174, 9316,
 BELDEN 8216, 83269, 83284, 84316 & TIMES LMR-100A CABLE

DIMENSIONS ARE IN INCHES AND [MILLIMETERS]	
UNLESS OTHERWISE NOTED TOLERANCES ARE:	
DECIMALS	DIAMETER
DRAWN C. ZUNIGA	6/3/99
CHECKED	
ORJ DRAWN C. ZUNIGA	11/10/97
APPROVALS	DATE

RF

connectors

7610 MIRAMAR RD
 SAN DIEGO, CA 92126
 (619)549-6340
 (619)549-6345 FAX

DIVISION OF RF INDUSTRIES, LTD.

RMX-8000-1B

MCX CRIMP PLUG

SIZE A	CABLE GROUP B	DWG NO. 8741	REV B
SCALE: 4:1		CAD FILE 13ARC B	SHEET 1 OF 1

ITEM	DESCRIPTION	QTY	MATERIAL	FINISH
6	FERRULE	1	COPPER	GOLD
5	HOUSING	1	BRASS	GOLD
4	DIELECTRIC	1	PTFE	NONE
3	DIELECTRIC	1	PTFE	NONE
2	PIN	1	BRASS	GOLD
1	BODY	1	BeCu	GOLD