

**Sealed Choke Coil SDEM25201T type**

■ **Features**

Low profile : 2.5mm x 2.0mm x 1.0mm

High performance (Isat) realized by metal dust core.

Low loss realized with low DCR

High magnetic shield construction should actualize high resolution for EMC protection.

100% lead (Pb) free meet RoHS standard

■ **Application**

DC/DC converter for CPU in Notebook PC

Cellular phones, LCD displays, HDDs, DVCs, DSCs, PDAs etc..

VRM for server

■ **Outline Dimensions**

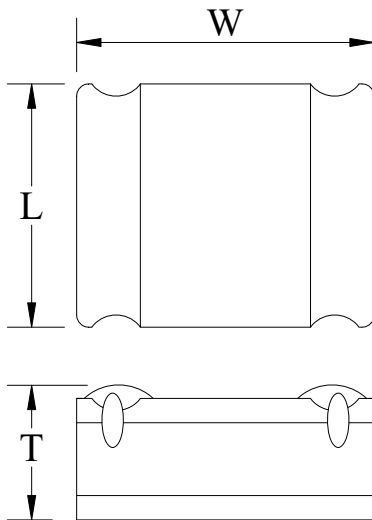

| Code | Dimensions (mm) |
|------|-----------------|
| L    | 2.0 ± 0.2       |
| W    | 2.5 ± 0.2       |
| T    | 1.0 Max.        |

Note: This graph is in regard to outline dimensions spec. For outer appearance, please refer to actual product.

■ **Recommend Land Pattern Dimensions**

The customer shall determine the land dimensions shown below after confirming and safety.

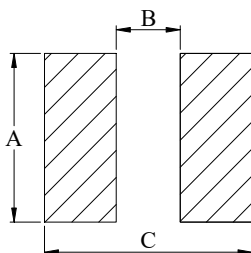

|   |     |
|---|-----|
| A | 2.1 |
| B | 0.8 |
| C | 2.6 |

Unit : mm

### ■ Specifications

| Part Number      | L0 Inductance<br>( $\mu\text{H}$ )<br>@ (0A) | $R_{dc}$ ( $\text{m}\Omega$ ) |         | Heat Rating Current<br>DC Amps. $I_{dc}$ ( A ) |         | Saturation Current<br>DC Amps. $I_{sat}$ ( A ) |         |
|------------------|--|-------------------------------|---------|--|---------|--|---------|
|                  |  | Typical                       | Maximum | Typical  | Maximum | Typical  | Maximum |
| SDEM25201T-R24MS | 0.24   | 19                            | 23      | 4.60   | 4.30    | 7.00   | 6.30    |
| SDEM25201T-R33MS | 0.33   | 24                            | 29      | 4.50   | 4.20    | 6.50   | 5.85    |
| SDEM25201T-R47MS | 0.47   | 29                            | 35      | 4.00   | 3.60    | 5.50   | 5.00    |
| SDEM25201T-R68MS | 0.68   | 39                            | 47      | 3.55   | 3.20    | 4.20   | 3.78    |
| SDEM25201T-1R0MS | 1.0  | 52                            | 62      | 3.30   | 3.00    | 4.00   | 3.60    |
| SDEM25201T-1R5MS | 1.5  | 84                            | 100     | 2.50   | 2.20    | 3.10   | 2.80    |
| SDEM25201T-2R2MS | 2.2  | 95                            | 115     | 2.15   | 1.97    | 2.60   | 2.30    |
| SDEM25201T-3R3MS | 3.3  | 180                           | 216     | 1.70   | 1.53    | 1.80   | 1.62    |
| SDEM25201T-4R7MS | 4.7  | 215                           | 258     | 1.60   | 1.45    | 1.70   | 1.55    |
| SDEM25201T-6R8MS | 6.8  | 350                           | 420     | 1.10   | 1.00    | 1.35   | 1.22    |
| SDEM25201T-100MS | 10.0   | 574                           | 689     | 0.95   | 0.85    | 1.20   | 1.10    |
| SDEM25201T-150MS | 15.0   | 925                           | 1110    | 0.58   | 0.52    | 0.80   | 0.72    |
| SDEM25201T-220MS | 22.0   | 1000                          | 1200    | 0.50   | 0.45    | 0.66   | 0.60    |

\* : If you require another part number please contact with us.

\*\* : Inductance Tolerance  $\pm 20\%$

Note 1. : All test data is referenced to 25°C ambient.

Note 2. : Test Condition; 1MHz, 1.0Vrms

Note 3. :  $I_{dc}$  : DC current (A) that will cause an approximate  $\Delta T$  of 40°C

Note 4. :  $I_{sat}$  : DC current (A) that will cause L0 to drop approximately 30%

Note 5. : Operating Temperature Range -55°C to +125°C

Note 6. : The part temperature (ambient + temp rise) should not exceed 125°C under the worst case operating conditions. Circuit design, component placement, PCB trace size and thickness, airflow and other cooling provision all affect the part temperature. Part temperature should be verified in the end application.

Note 7. : The rated current as listed is either the saturation current or the heating current depending on which value is lower.

### Current Characteristic

