

APPROVED: \_\_\_\_\_  
 DATE: \_\_\_\_\_ TITLE: \_\_\_\_\_

Rev	AWO #	Description	Date	Appr
-		RELEASED	9/8/20	
A		UPDATE DRAWING	11/4/20	LH/JL

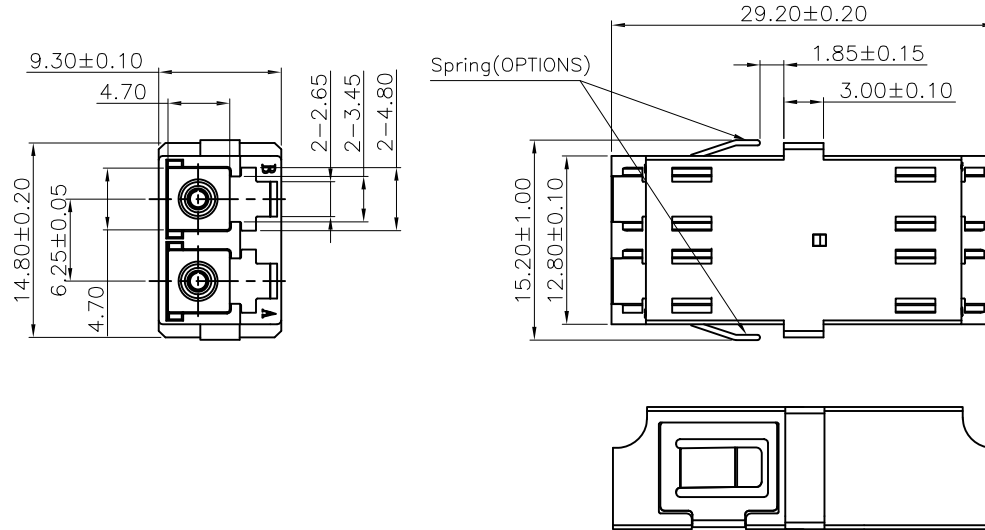
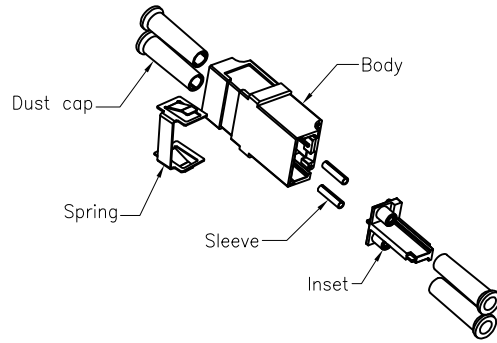

OPLD2BNNC1NA	PEI Aquatic Blue	W/O
OPLD2BNNC1PA	PEI Aquatic Blue	W/
OPLC2BNNC1NA	PBT Beige 7501U	W/O
OPLA2BNNC1NA	PBT Green 7737C	W/O
OPLC2BNNC1PA	PBT Beige 7501U	W/
OPLA2BNNC1PA	PBT Green 7737C	W/
OPLB2BNNC1NA	PEI Blue 2184C	W/O
OPLB2BNNC1PA	PEI Blue 2184C	W/
Part name	Material, Color	EMI

**SPECIFICATIONS:**

Material:  
 Housing: See Chart, rated UL 94V-0, Color: See Chart  
 Cap: PP, rated UL 94V-0, Color: White  
 Spring: SUS  
 Sleeve: Zirconia Ceramic  
 Electrical:  
 Standards of IEC 61754-20, YD/T 1272.1-2003  
 Repeatability: 1000 min times  
 Insertion loss: 0.2dB max  
 Interchangeability: 0.2dB  
 Temperature Rating:  
 Operating temperature: -40°C to +85°C  
 Environmental:  
 Lead free, RoHS compliant.



UNLESS OTHERWISE SPECIFIED  
 ALL DIMENSIONS ARE MILLIMETERS  
 TOLERANCES: EXCEPT AS NOTED  
 MM ANGLE  
 X. ± 0.35 X.\* ± 2°  
 .X ± 0.30 .X\* ± 1°  
 .XX ± 0.25 .XX\* ± 0.5°  
 .XXX ± 0.15 .XXX\* ± 0.5°

**ADAM TECH**  
 INTERCONNECTS  
 909 Rahway Avenue,  
 Union, NJ 07083  
 Phone: 908-687-5000  
 Fax: 908-687-5710

APPROVALS		DATE
DRAWN	OW	9/8/20
CHECKED	JL	9/8/20
APPROVED		

TITLE			
OPTICAL LC ADAPTERS, APC&PC&MM, 2 PORTS SHORT EARS, WITH LC DUST CAP			
SIZE	PART NO.	REV.	
X	OPLX2BNNC1XA	A	
REF:	S00005C	SCALE: NTS	SHEET 1 OF 1