

THIS DRAWING CONTAINS INFORMATION PROPRIETARY TO RF INDUSTRIES,  
 ANY UNAUTHORIZED USE OF THIS DRAWING IS EXPRESSLY PROHIBITED  
 WITHOUT WRITTEN PERMISSION FROM RF INDUSTRIES.  
 ANY VIOLATION IS PUNISHABLE UNDER U.S. COPYRIGHT LAWS.

ALL DIMENSIONS ARE REFERENCE ONLY

PART NO.		<b>RFE-6101</b>		
REV	DESCRIPTION	DWN	DATE	APPROVED
-	ENGINEERING RELEASE	CZS	04/06/09	JDMc

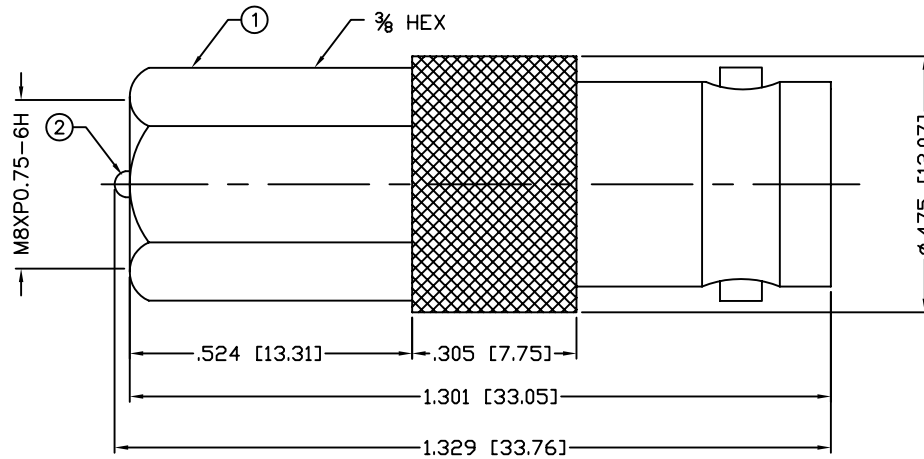

**SPECIFICATIONS:**

IMPEDANCE: 50 Ohms  
 FREQUENCY RANGE: 0-2 GHz  
 WORKING VOLTAGE: 335 Vrms  
 INSULATION RESISTANCE: 5k M ohms min.  
 TEMPERATURE RANGE: -65°C TO +85°C

14						
13						
12						
11						
10						
9						
8						
7						
6						
5						
4						
3	INSULATOR	1	PTFE	---		
2	CONTACT/PIN	1	BRASS	GOLD, 3μ"		
1	BODY	1	BRASS	NICKEL, 100μ"		
#	DESCRIPTION	QTY	MATERIAL	FINISH	APPROVALS	DATE

000494	
DRAWN	04/06/09
C. ZUNIGA	
CHECKED	
ORJ DRAWN	04/06/09
C. ZUNIGA	

**RoHS COMPLIANT**

DIMENSIONS ARE IN INCHES AND [MILLIMETERS]  
 UNLESS OTHERWISE NOTED TOLERANCES ARE:

DECIMALS	DIAMETER
----------	----------

**RF connectors**  
 DIVISION OF RF INDUSTRIES, LTD.

7610 MIRAMAR RD  
 SAN DIEGO, CA 92126  
 (858) 549-6340  
 (858) 549-6345 FAX

**FME PLUG TO BNC JACK ADAPTER**

SIZE	CABLE GROUP	DWG NO.	REV
A	N/A	RFE-6101	-

SCALE: NTS      CAD FILE OUTLINE      SHEET 1 OF 1